



Spirit

Parts list Spirit

Contents

Duette; boiler related parts: overview.....	3
Duette; inlet to manifold to water meter, mix-block and steam boiler, overview.....	3
Duette; inlet to manifold to water meter, mix-block and steam boiler, exploded view.....	4
Duette, pump per group; inlet to manifold to water meter, mix-block and steam boiler, exploded view.....	5
Duette; discharge, overview.....	6
Duette and Triplette; coffee boiler fill, overview.....	6
Duette; discharge, exploded view.....	7
Duette; coffee boiler fill, exploded view.....	8
Duette and Triplette; coffee boiler, exploded view 1 (components in machine body).....	9
Duette and Triplette; coffee boiler, exploded view 2 (components of/on group head).....	10
Duette and Triplette; steam boiler LHS: overheat protection, anti-vacuum and sensor cable.....	11
Duette and Triplette, bastone version; steam, hot water and group control.....	12
Duette and Triplette; various electrical components 1.....	13
Duette and Triplette; various electrical components 2.....	14
Triplette; inlet to manifold to water meter and mix-block, overview.....	15
Triplette, pump per group; inlet to manifold to water meter and mix-block, overview.....	15
Triplette; inlet to manifold to water meter and mix-block, exploded view.....	16
Triplette, pump per group; inlet to manifold to water meter and mix-block, exploded view.....	17
Triplette; discharge, overview.....	18
Triplette; steam boiler and ducts, overview.....	18
Triplette; discharge, exploded view.....	19
Triplette; coffee boiler fill, exploded view.....	20
Duette and Triplette; steam and hot water, (semi-) exploded view steam.....	21
Duette and Triplette; steam and hot water, (semi-) exploded view hot water.....	22
Duette and Triplette pressure gauges.....	23
Duette and Triplette heating elements with fixtures.....	24
Evolution of handle versions in Spirit, overview.....	25
Steam handle, mechanical version.....	26
Steam handle, electrical version.....	27
Bastone group handle, version 1 (no switches).....	28
Bastone group handle, version 2 (with program and volume switch).....	29
Bastone group handle, version 3 (with program and volume switches and indicator LED).....	30
Hot water handle, versions 1 and 2.....	31
Duette and Triplette; mix-block (with stainless steel flange valve).....	32
Duette; manifold (with stainless steel flange valves).....	33
Triplette; manifold (with stainless steel flange valves).....	34
Duette, pump per group; manifold (with stainless steel flange valves).....	35
Triplette, pump per group; manifold (with stainless steel flange valves).....	36



Duette; boiler related parts: overview

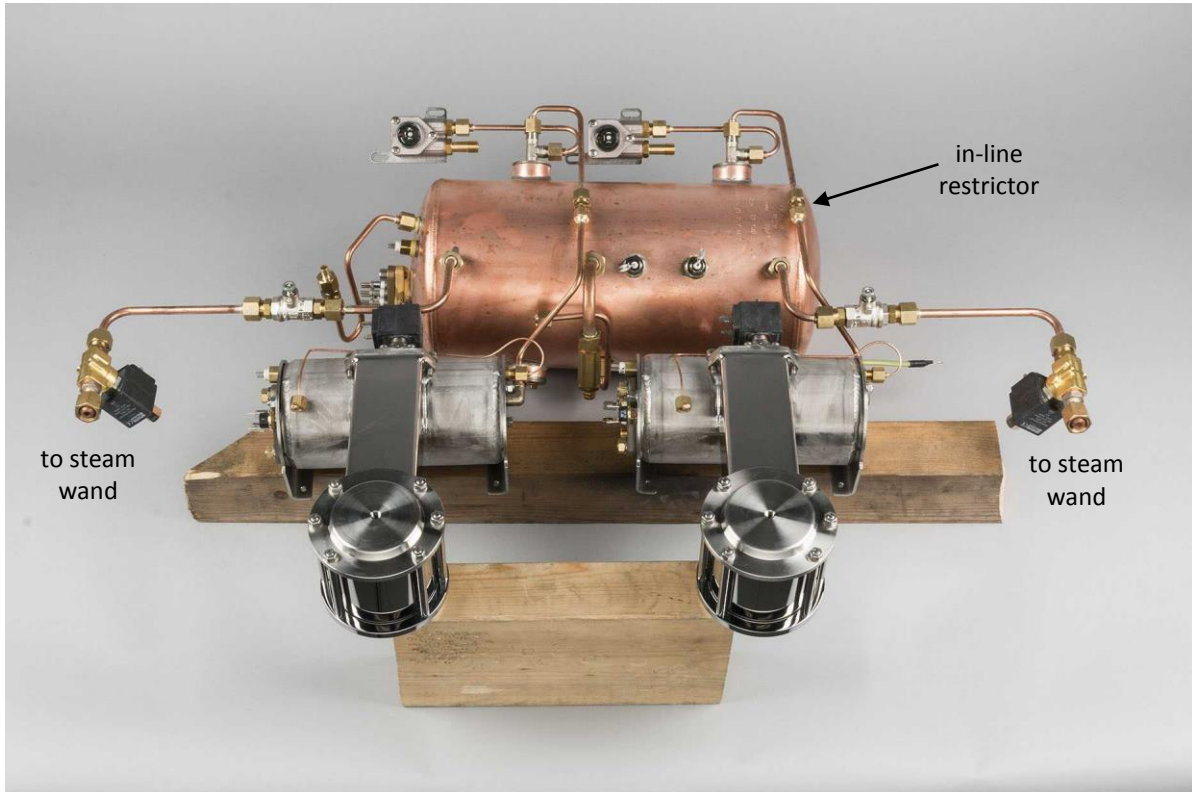

Duette; inlet to manifold to water meter, mix-block and steam boiler, overview

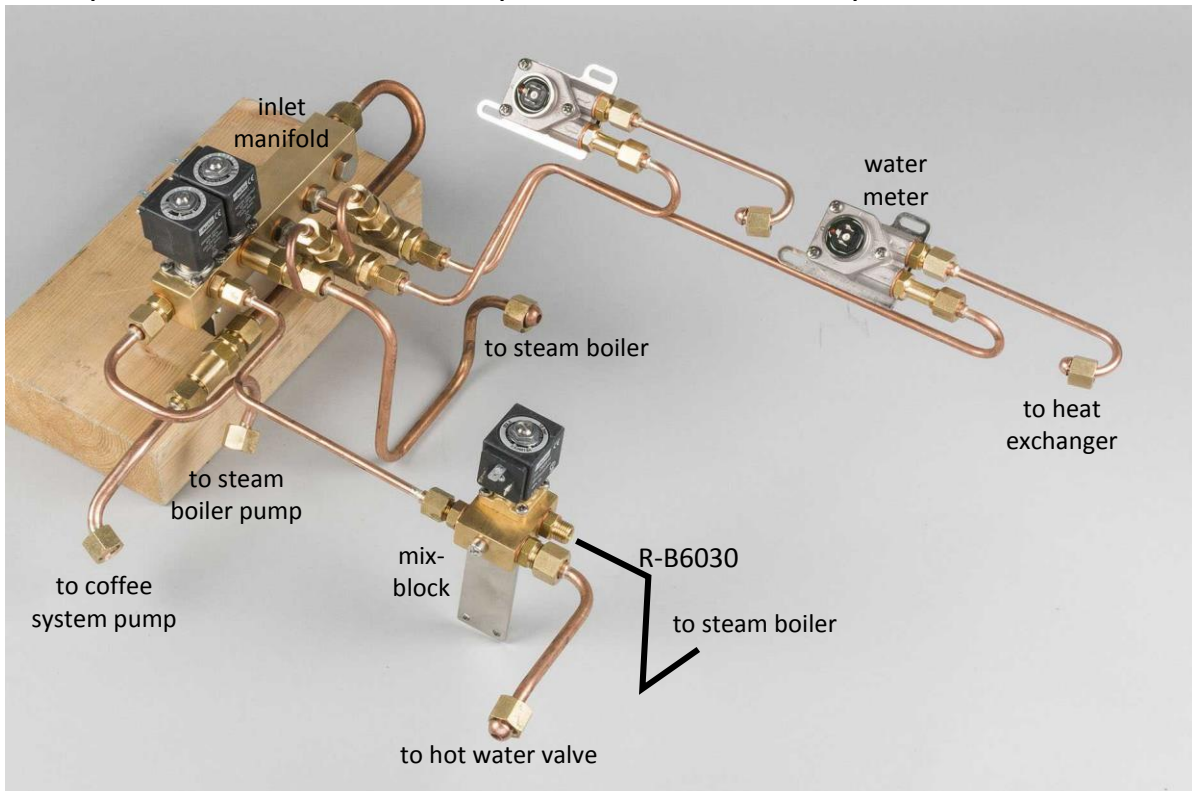

Duette; inlet to manifold to water meter, mix-block and steam boiler, exploded view

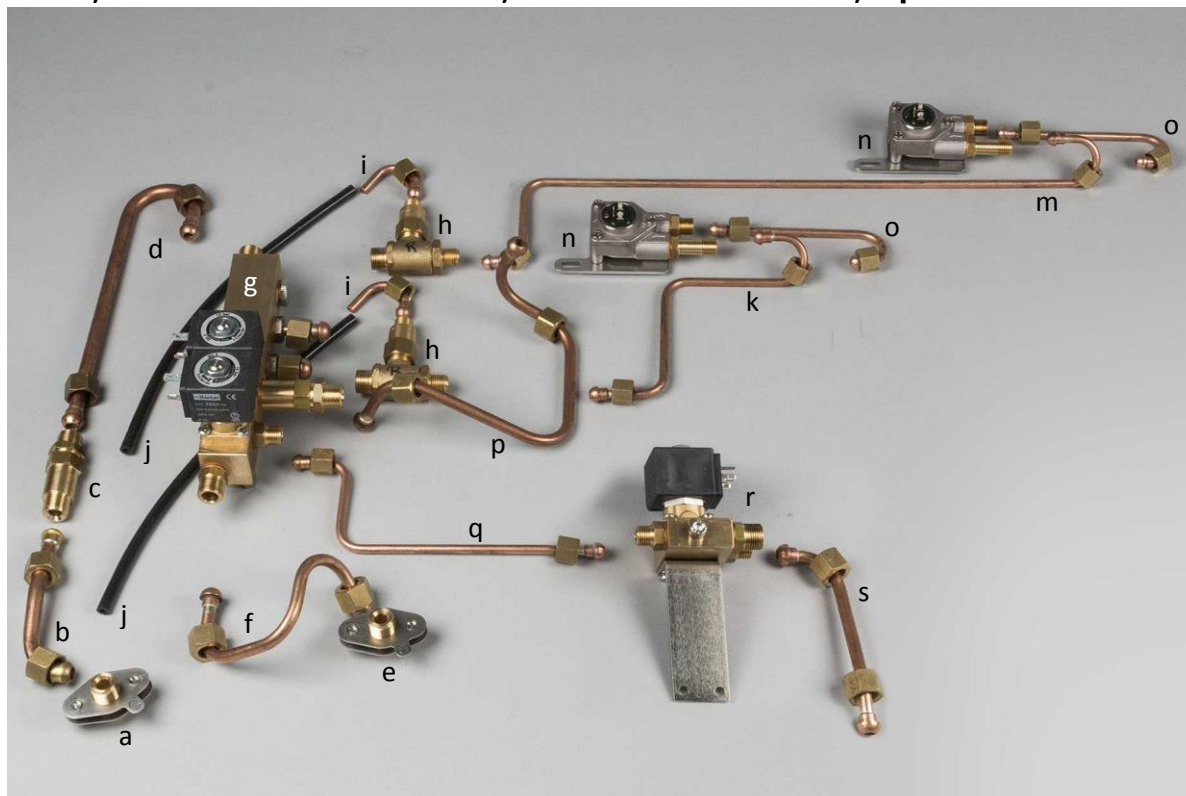

	Part	Number	remark
	stainless steel mounting plate with nuts, marked "C"	R-F6018-C	
a	stainless steel inlet mounting plate	R-F6017	
	brass inlet fitting, 3/8M-3/8M	MSR-A009-F	
b	10 mm copper tube, inlet fitting ↔ one-way valve	R-B6027	
c	brass one-way valve, 3/8M-3/8M	MR-B029	
d	10 mm copper tube, one-way valve ↔ manifold	R-B6028	
	stainless steel mounting plate with nuts, marked "S"	R-F6018-S	
e	stainless steel inlet mounting plate	R-F6017	
	brass inlet fitting, 3/8M-3/8M	MSR-A009-F	
f	8 mm copper tube, inlet fitting ↔ manifold	R-B6026-v1	
g	manifold Spirit Duette 2-pump machine, complete	R-B6004-DC	see p. ...
h	brass combi valve (one-way/expansion)	R-B6101-IC	
i	6 mm copper tube, combi valve ↔ discharge hose	R-B6023	
j	black silicone hose, combi valve ↔ discharge pipe	R-B6079	4x8mm, 28cm
k	6 mm copper tube, combi valve ↔ water meter L	R-B6036-L	
m	6 mm copper tube, combi valve ↔ water meter R	R-B6036-DR	
n	water meter, complete (fittings, mounting plate)	R-E6131-C	see p. ...
o	6 mm copper tube, water meter ↔ heat exchanger	R-B6022-v1	
p	8 mm copper tube, manifold ↔ steam boiler	R-B6035	
q	6 mm copper tube, manifold ↔ mix-block	R-B6029-D	
r	mix-block Spirit, complete	R-B6003-C	see p. ...
s	8 mm copper tube, mix-block ↔ front fitting	R-B6031	
n.i.p.	6 mm copper tube, steam boiler ↔ mix-block	R-B6030	



Duette, pump per group; inlet to manifold to water meter, mix-block and steam boiler, exploded view



	Part	Number	remark
a	stainless steel inlet fitting mounting plate with nuts, marked "L"	R-F6018-L	
	stainless steel inlet mounting plate	R-F6017	
	brass inlet fitting, 3/8M-3/8M	MSR-A009-F	
b	stainless steel inlet fitting mounting plate with nuts, marked "R"	R-F6018-R	
	stainless steel inlet mounting plate	R-F6017	
	brass inlet fitting, 3/8M-3/8M	MSR-A009-F	
c	6 mm copper tube, inlet fitting ↔ manifold L-gr	R-B6026-PL	
d	6 mm copper tube, inlet fitting ↔ manifold R-gr	R-B6026-PM	
g	manifold Spirit Duette pump per group, complete	R-B6114-D	see p. ...
n.i.p.	6 mm copper tube, steam boiler ↔ mix-block	R-B6030	

all other items as previous page



Duette; discharge, overview

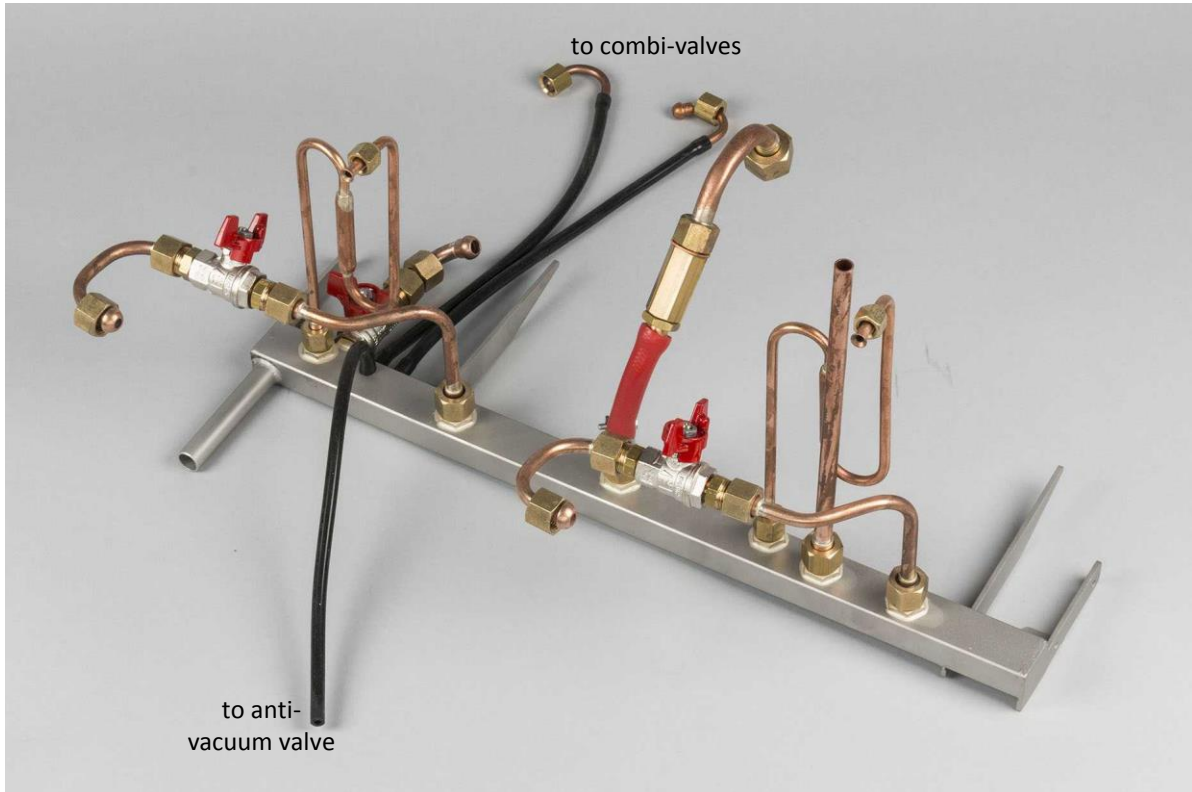

Duette and Triplette; coffee boiler fill, overview

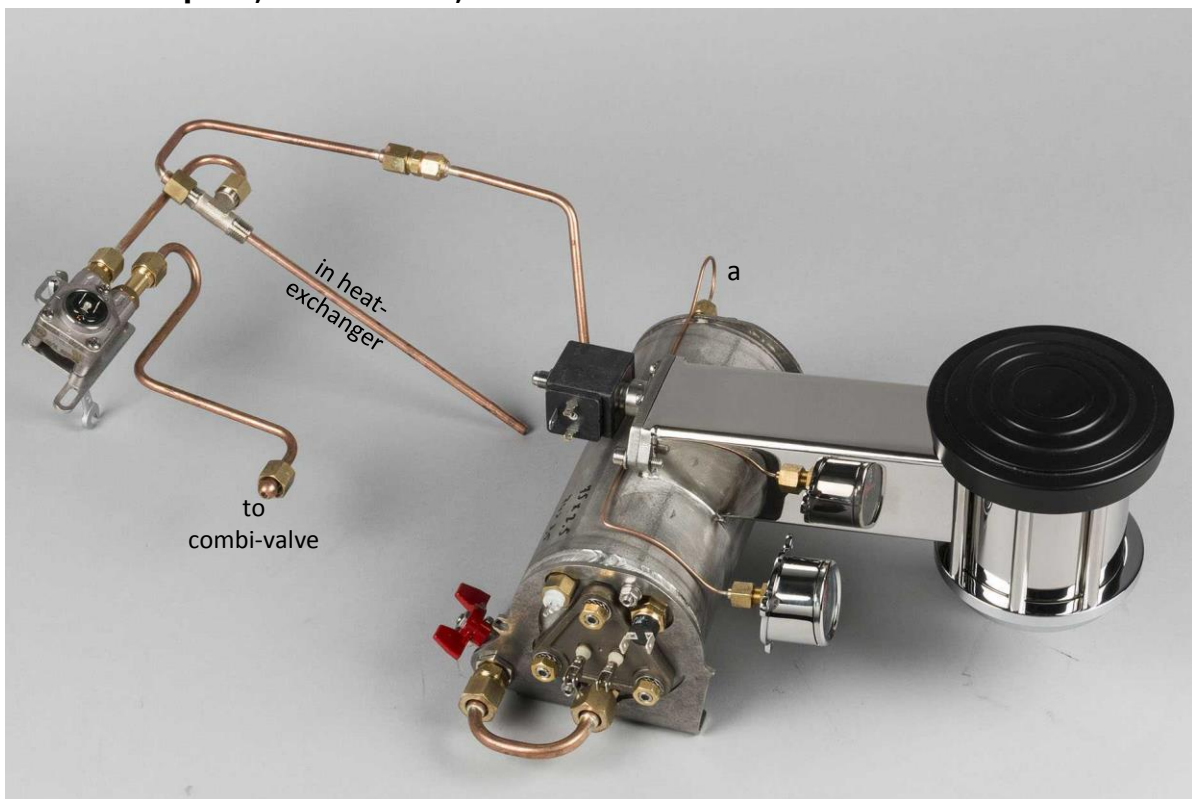

	Part	Number	remark
a	2 mm copper tube, coffee boiler ↔ pressure gauge	SR-B1045	



Duette; discharge, exploded view

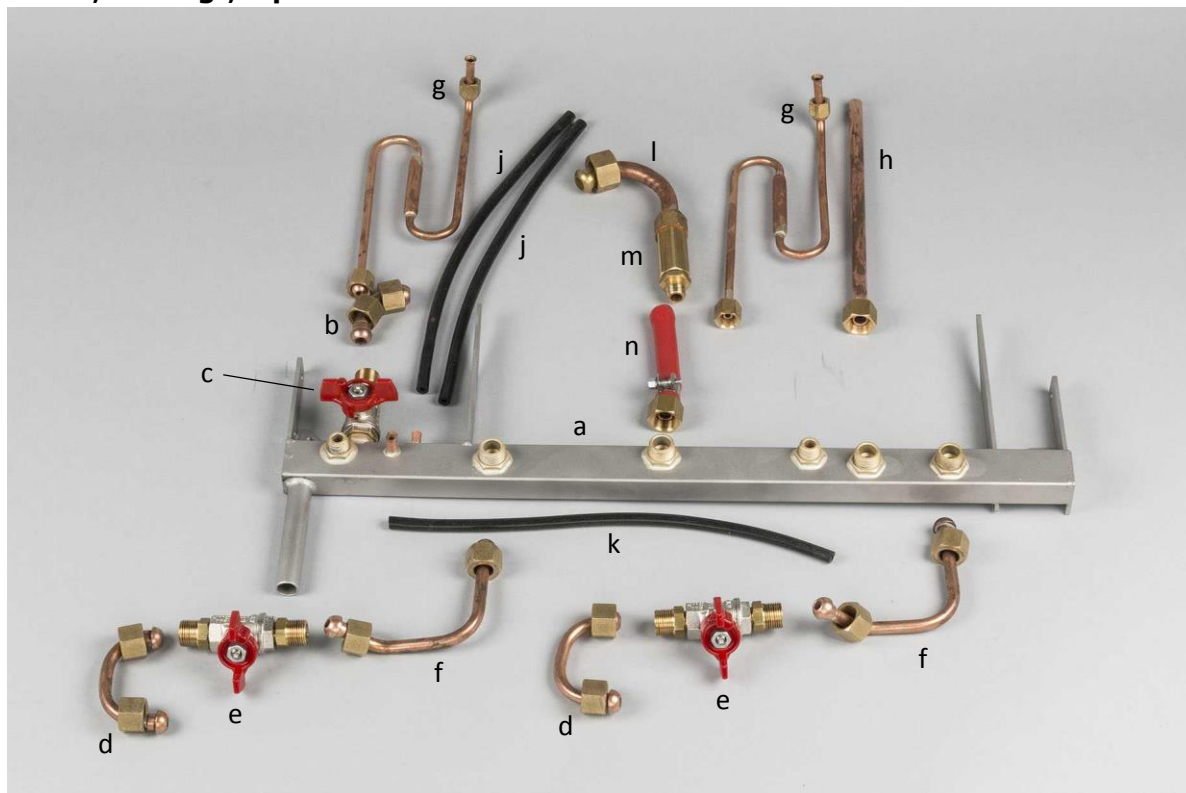

Part	Number	remark	
a	stainless steel main discharge pipe, Duette	R-B6025-D	
b	10 mm copper tube, steam boiler ↔ discharge valve	R-B6054	
c	butterfly handle ball valve with one fitting, 1/4M-3/8M	MSR-B076 MSR-S037	
d	8 mm copper tube, coffee boiler ↔ discharge valve	R-B6050	
e	butterfly handle ball valve with two fittings, 1/4M-3/8M	MSR-B076 MSR-S037	as set: R-G6076-C
f	8 mm copper tube, discharge valve coffee boiler ↔ discharge pipe	R-B6051	
g	6 mm copper tube, group valve ↔ discharge pipe	R-B6052	
h	10 mm copper tube, discharge areator	R-B6053	
j	black silicone hose, combi valve ↔ discharge pipe	R-B6079	4x8mm, 28cm
k	black silicone hose, anti-vacuum valve ↔ discharge pipe	R-B6079	4x8mm, 28cm
l	12 mm copper tube, steam boiler ↔ pressure safety valve	MR-B081-T	as set:
	copper O-ring, 3/8	MSR-B078	MR-B081-TC
m	brass pressure safety valve	MR-B032	
n	red silicone reinforced hose	R-B6070	8x14.5, 8.5cm
	8 mm copper tube with fitting nut	R-B6062 L-W0038	
	stainless steel hose clamp	C-HK-12-22	



Duette; coffee boiler fill, exploded view

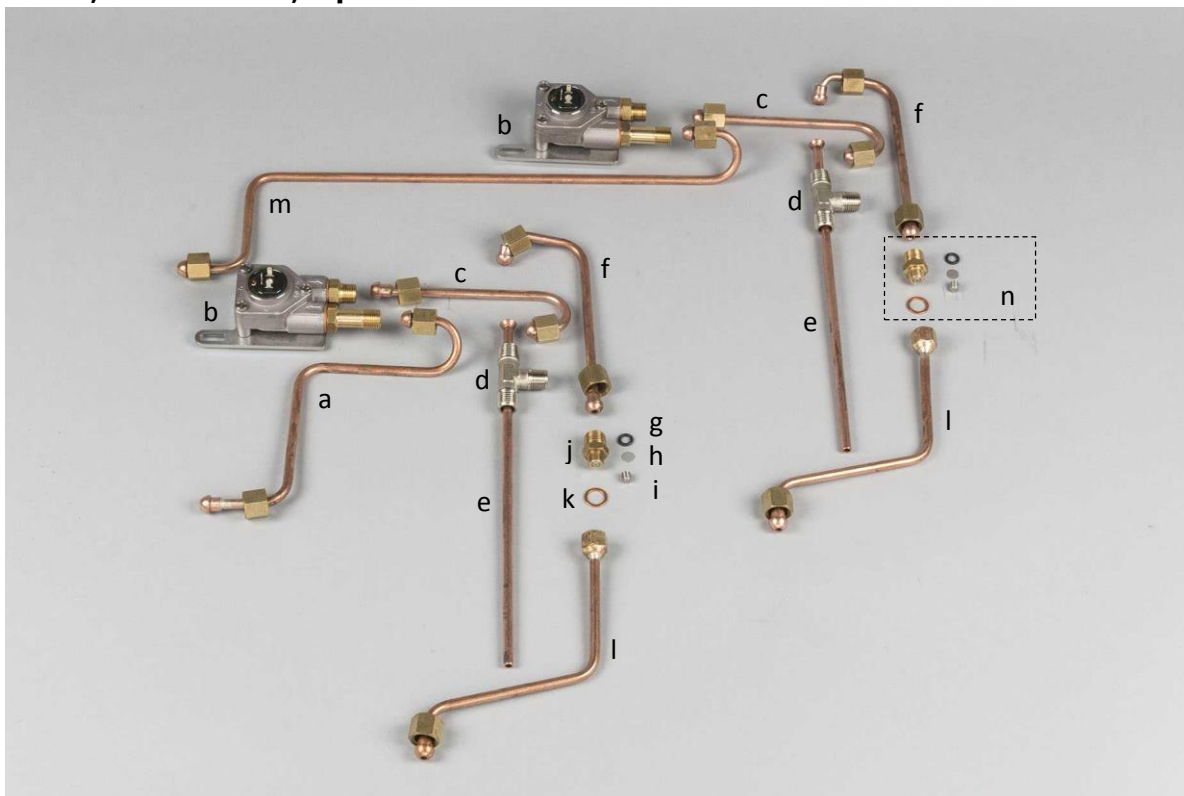

	Part	Number	remark
a	6 mm copper tube, combi valve ↔ water meter L	R-B6036-L	
b	water meter, complete (fittings, mounting plate)	R-E6131-C	see p. ..
c	6 mm copper tube, water meter ↔ heat exchanger	R-B6022-v1	
d	nickel plated brass T-fitting, 1/4M	SR-B1008	
e	6 mm copper tube, injection tube in heat exchanger	R-B6037	
f	6 mm copper tube, heat exchanger ↔ restrictor	R-B6039-V1	
g	Viton O-ring in restrictor housing	MSR-G1007-A	
h	stainless steel mesh in restrictor housing	MSR-B036-B	
i	stainless steel restrictor, 0.5mm diameter	MSR-B034-05	
	stainless steel restrictor, 0.6mm diameter	MSR-B034-06	
	stainless steel restrictor, 0.7mm diameter	MSR-B034-07	
	stainless steel restrictor, 0.8mm diameter	MSR-B034-08	
j	brass restrictor housing, 1/4M-1/8M	MSR-B035-B	
k	copper O-ring, 1/8	MSR-B082	
l	6 mm copper tube, restrictor ↔ coffee boiler	R-B6040	
m	6 mm copper tube, combi valve ↔ water meter R	R-B6036-DR	
n	restrictor in housing complete, 0.6 mm diameter	MSR-B035-C06	



Duette and Triplette; coffee boiler, exploded view 1 (components in machine body)

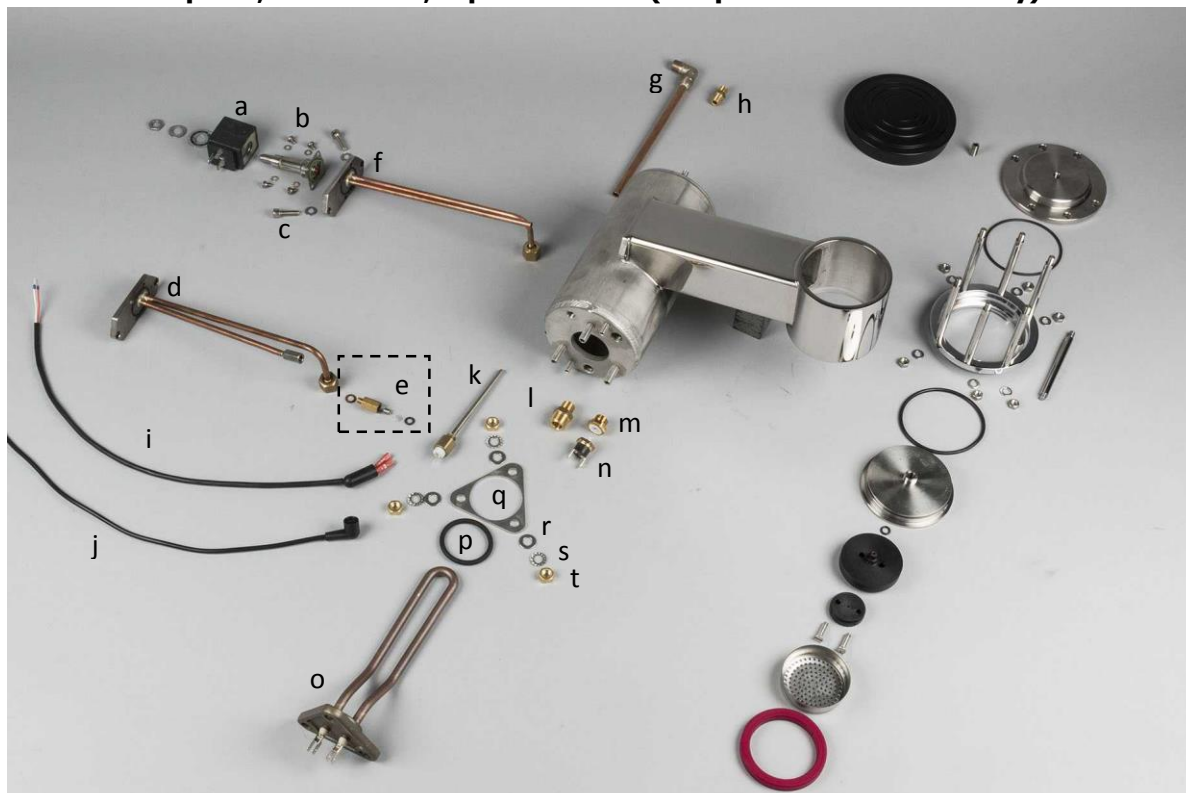

	Part	Number	remark
a	stainless steel 3-way group valve with solenoid, 230VAC	SR-E1023-230	
b	stainless steel screw, Din7985 M4x6 and	C-SK-M4x06	
	stainless steel lock washer, Din6798A M4	C-RT-M4	
c	stainless steel bolt, Din912 M6x20 and	C-BZ-M6x20	
	stainless steel washer, Din125A M6	C-RS-M6	
d	group valve mounting plate with tubing		replaced by f
e	in-group restrictor housing, complete	VSR-G1030-C	
f	group valve mounting plate with tubing (no O-ring) O-ring (25x2.5V75), for in-group restrictor	R-G6042 SR-B1041-v1	
g	8 mm copper inlet tube with brass L-fitting 1/4M-1/4M	SR-B1046-v1	
h	brass fitting, 1/8M-1/8M	SR-B1039	
i	temperature sensor cable with fastons and rubber cap	ZMR-E1005-KR	cap: C-HK-G
j	temperature sensor cable with molded angular plug	MR-E1005-KH	575mm
k	Pt100 temperature sensor for coffee boiler	SR-E1004-T	100mm
l	brass fitting, 1/4M-3/8M (for discharge)	MSR-S037	
m	brass fitting, 1/4M-M3 (for overheat protection)	SR-G1018	
n	overheat protection switch, 107°C, auto-reset	SR-E1018-V	
o	coffee boiler heating element; 900W 230V	SR-E1020	
p	Viton O-ring, 39X4.5V75	SR-B1010-v2	
q	stainless steel spacer for O-ring	SR-E1070	
r	stainless steel washer, Din125A M8	C-RS-M8	
s	stainless steel lock washer, Din6797J M8	C-RT-M8	
t	brass nut, M8	SR-G1017	



Duette and Triplette; coffee boiler, exploded view 2 (components of/on group head)

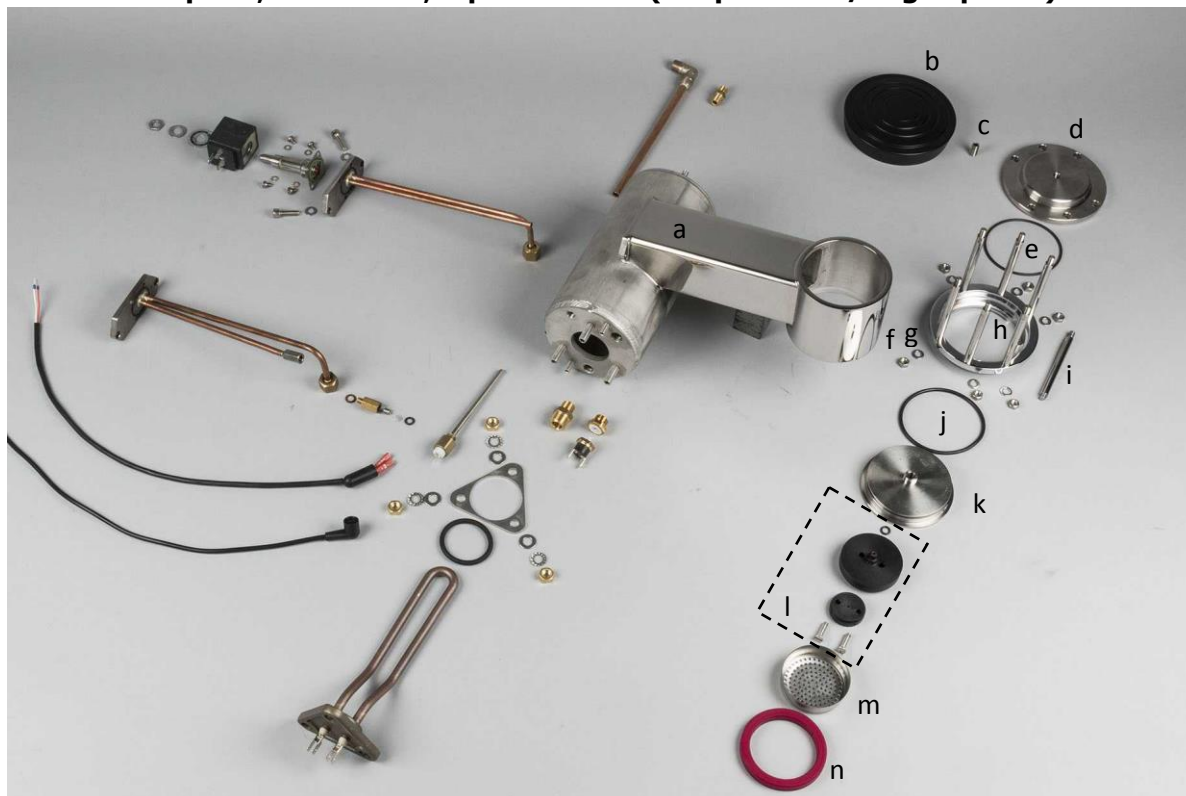

	Part	Number	remark
a	stainless steel coffee boiler	SR-G1001-Bv3	
b	plastic group cap	SR-G1010-B	
c	stainless steel set screw, Din916 M8x16	C-SS-M8x16	
d	stainless steel group cap	SR-G1002-v2	
e	Viton O-ring, top of group (75x2.5V75)	S-G1004-C	
f	stainless steel nut, Din934 M6	C-MH-M6	
g	stainless steel washer, Din125A M6	C-RS-M6	
h	chromed brass group bayonet (without rods)	S-G1006-v2	
i	stainless steel group head rod	S-G1005-v2	
j	Viton O-ring, bottom of group (74x3.5V75)	S-G1004-B	
k	stainless steel group bottom	S-G1003-v2	
l	Viton O-ring	MSR-G1007-A	as set: SR-G1009-C
	POM dispersion base	sold only as set: S-G1009	
	POM dispersion plate		
	stainless steel machine screws, Din963 M5x20	C-SC-M5x20	
m	stainless steel group shower	MSR-G013	
n	group ring	MSR-G014-80A	



Duette and Triplette; steam boiler LHS: overheat protection, anti-vacuum and sensor cable

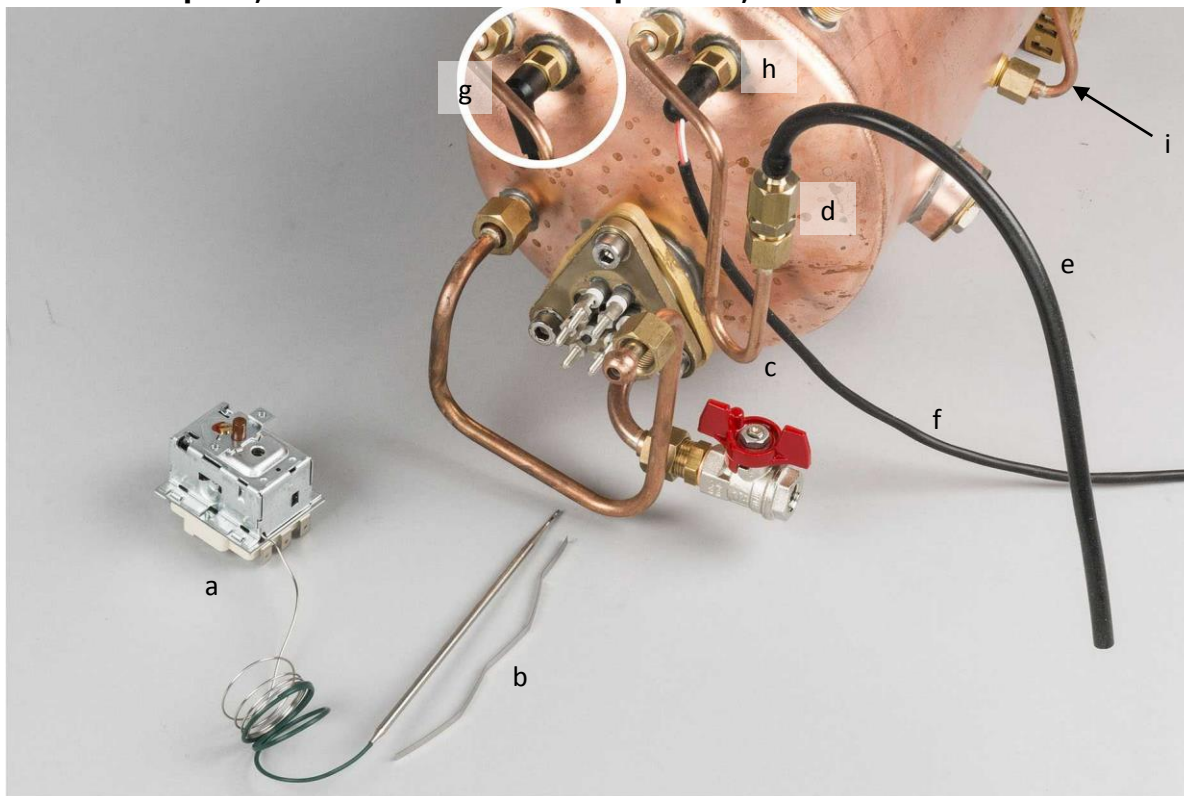

	Part	Number	remark
a	3-phase overheat protection switch, manual reset	MR-E033-3	155°C
b	stainless steel temperature probe clamp	MR-E130-S	
c	6 mm copper tube, steam boiler ↔ anti-vacuum valve	R-B6060	
d	brass anti-vacuum valve	MSR-B033	
e	black silicone hose, anti-vacuum valve ↔ discharge pipe	R-B6079	4x8mm, 28 cm
f	temperature sensor cable with fastons, no longer available	ZMR-E1005-KR	replaced by g
	rubber cap	C-HK-G	
g	temperature sensor cable with molded angular plug	MR-E1005-KH	575mm
h	Pt100 temperature sensor steam boiler (27 mm)	MSR-E1005-T	brass probe
i	6mm copper tube, steam boiler ↔ mix-block	R-B6030	



Duette and Triplette, bastone version; steam, hot water and group control

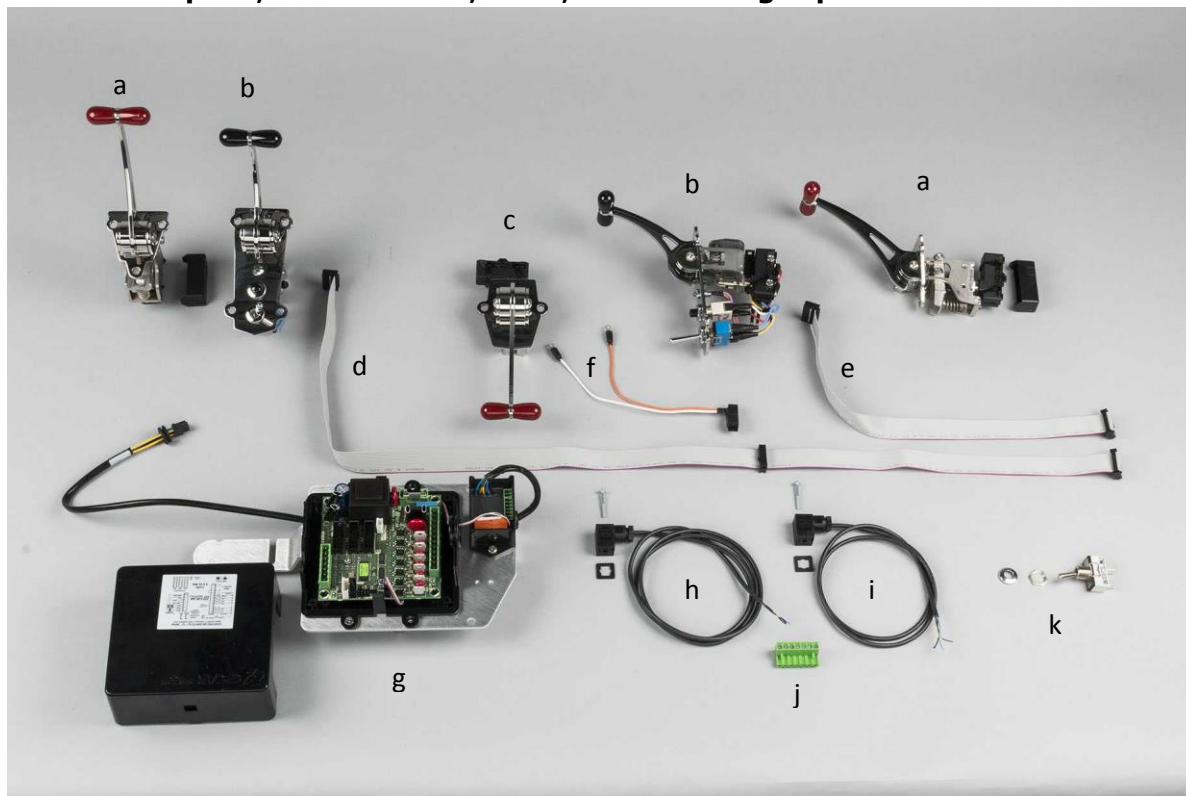

	Part	Number	remark
a	steam handle, complete	R-S6109-C	see p. ..
b	group handle with volume and program switches and indicator light, complete	R-G6023-CL	see p. ..
c	hot water handle, complete	R-S6013-C	see p. ..
d	ribbon cable (910mm) with HWC-plug, left group Duette	R-E6023-DL-v2	set for Duette:
e	ribbon cable (370mm), right group, Duette	R-E6023-RR-v2	R-E6123-D
f	hot water cable (HWC; plugs into d)	R-E6024	
n.i.p.	ribbon cable (120mm) with HWC-plug, left group Triplette	R-E6023-TL-v2	set for Triplette:
n.i.p.	ribbon cable (945mm), center group, Triplette	R-E6023-TM-v2	R-E6123-T
e	ribbon cable (370mm), right group, Triplette	R-E6023-RR-v2	
g	Gicar main controller, LLV - 240VAC	R-E017-v2	
	Gicar mounting plate	R-F6050-v3	
	combi-PCB for shot-timers and steam pump control	R-E6081	
n.i.p.	water meter cable (1400mm), left group Triplette, w. seal and screw	R-E6032-T	
h	water meter cable (1150mm), left group Duette/center group Triplette, w. seal and screw	MR-E032-T	
i	water meter cable (850mm), right group Duette & Triplette w. seal and screw	MR-E032-D	
j	7-pole green plug (comes in set together with 12-pole plug)	MR-E017-S	
k	back-light switch w. fixtures	SR-E1041	



Duette and Triplette; various electrical components 1

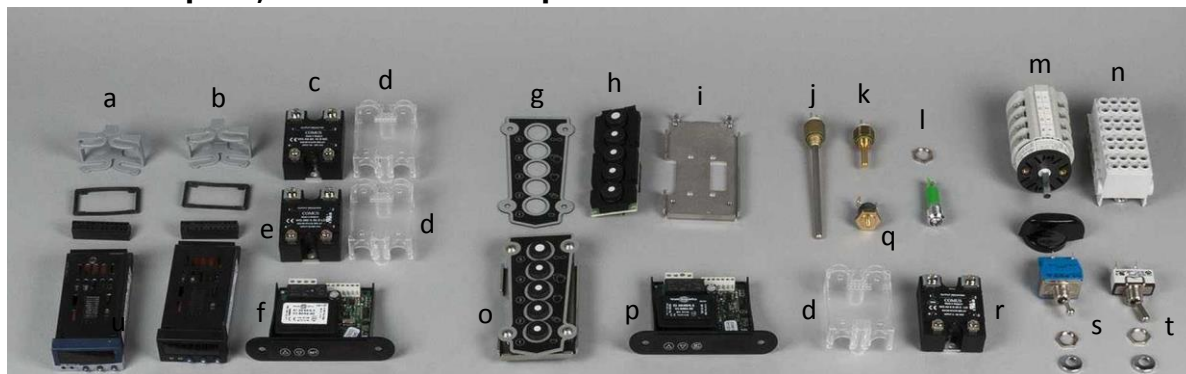

	Part	Number	remark
a	JUMO Di32 steam boiler controller w. fixtures; no longer available	ZS-E1003-Di	up to # ... replaced by b
b	JUMO iTron specify °C or °F, specify coffee or steam, specify 2-lead or 3-lead temperature probe	ZSR-E1003-iT	up to # ...
c	SSR NC, 90-280VAC control power, without silpad	SR-E1010-NC	up to # ...
d	clear plastic SSR cover	MSR-E009	
	silpad (heat transfer sticker) for SSR	MSR-E008-P	
e	SSR NO, 90-280VAC control power, without silpad	MR-E008-NO	up to # ...
f	Störk steam boiler controller, red display; no longer available		see p
g	touchpad cover	MR-F6009-5	
h	touchpad with button-LED's, 5-buttons	MR-E6061	
i	touchpad mounting plate	R-F6053-v1	
j	Pt100 temperature sensor, coffee boiler (100 mm)	SR-E1004-T	stainless probe
k	Pt100 temperature sensor, steam boiler (27 mm)	MSR-E1005-T	brass probe
l	green LED indicator light w. nut	MR-E6012-G	
m	4x4p 3-position mains switch w. knob	MR-E105	
n	mains power connector block	MR-E050	
o	touchpad, 5-buttons, complete		
p	Störk ECO controller, green display, 220-240V specify coffee or steam boiler and °C or °F	MSR-E1003-ST	
	Störk ECO controller, green display, 190-210V specify coffee or steam boiler and °C or °F	MSR-E1003-SJ	
q	Overheat protection switch coffee boiler, auto-reset	SR-E1018-V	107°C
r	SSR NO, 3-32VDC control power, without silpad	MSR-E1010-NO	see below d
s	controller switch w. fixtures	SR-E6040	
t	back light switch w. fixtures	SR-E1041	



Duette and Triplette; various electrical components 2

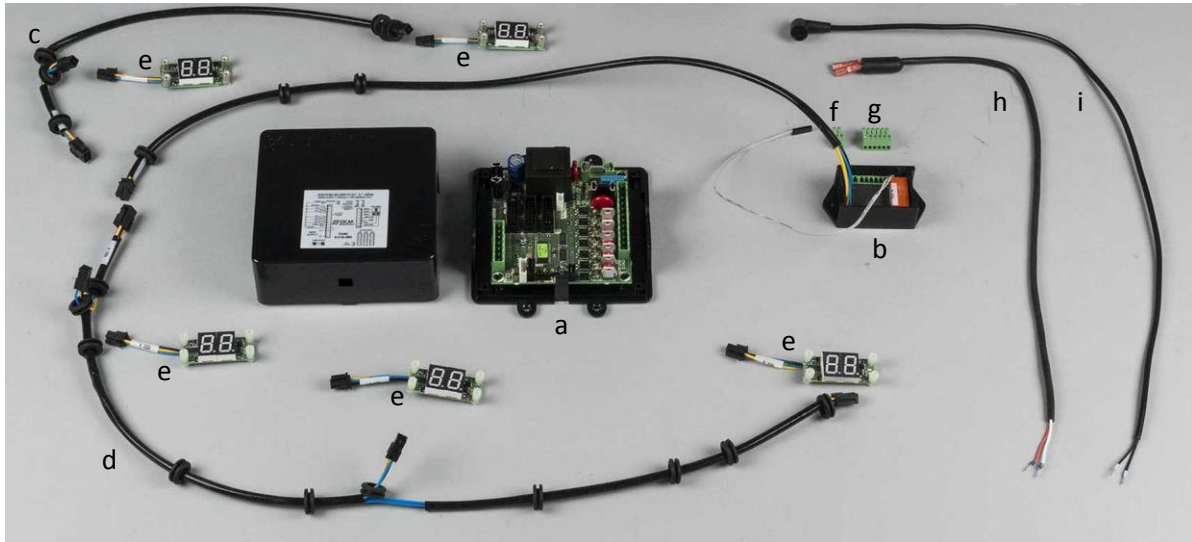

	Part	Number	remark
a	Gicar LLV main controller, 240VAC w. cover	R-E017-v2	
b	combi-PCB for shot timers and steam boiler pump	R-E6081	
c	adapter cable for shot timers, Duette only	R-E6084-D	
d	adapter cable for shot timers, Triplette only	R-E6084-T	
e	shot timer	SR-E6080	
f	2-pole green plug	R-E6083	set of 2 plugs
g	6-pole green plug		
h	temperature sensor cable with fastons, no longer available	ZMR-E1005-KR	replaced by i
	rubber cap	C-HK-G	
i	temperature sensor cable with molded angular plug	MR-E1005-KH	575mm



Triplette; inlet to manifold to water meter and mix-block, overview

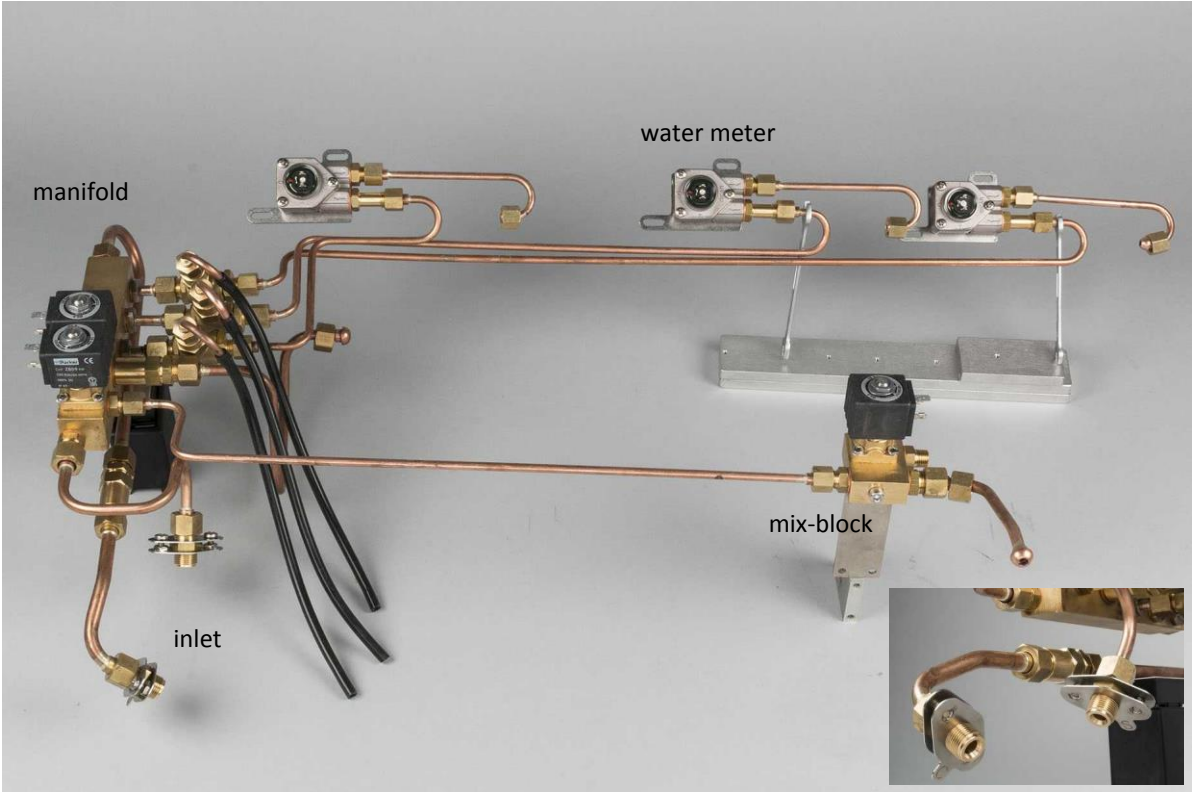

Triplette, pump per group; inlet to manifold to water meter and mix-block, overview

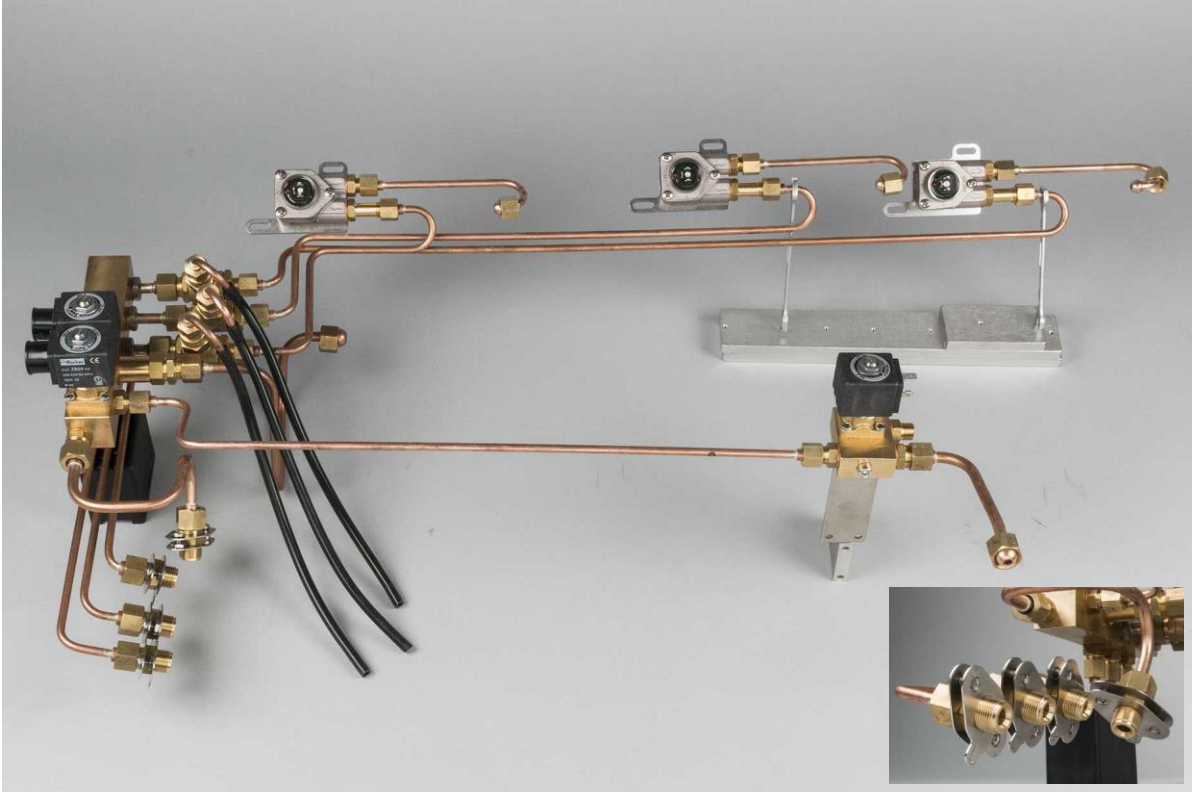

Triplette; inlet to manifold to water meter and mix-block, exploded view

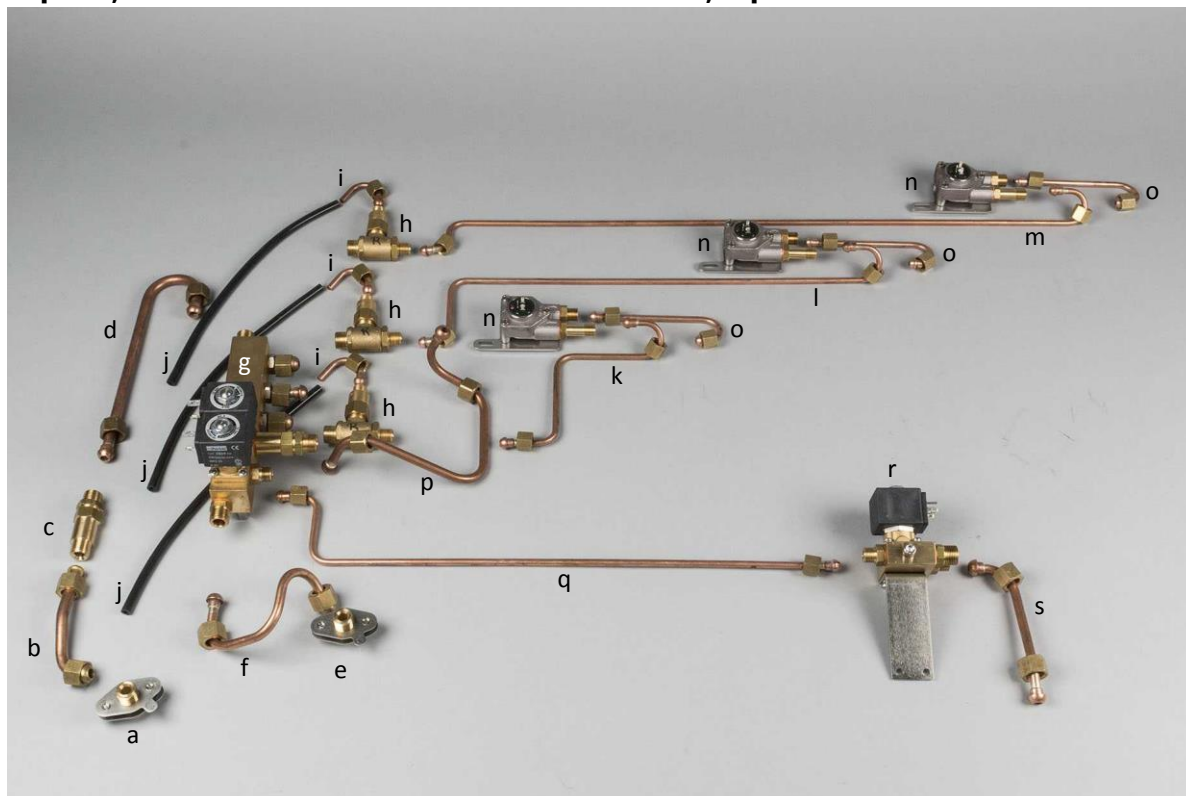

	Part	Number	remark
	stainless steel mounting plate with nuts, marked "C"	R-F6018-C	
a	stainless steel inlet mounting plate	R-F6017	
	brass inlet fitting, 3/8M-3/8M	MSR-A009-F	
b	10 mm copper tube, inlet fitting ↔ one-way valve	R-B6027	
c	brass one-way valve, 3/8M-3/8M	MR-B029	
d	10 mm copper tube, one-way valve ↔ manifold	R-B6028	
	stainless steel mounting plate with nuts, marked "S"	R-F6018-S	
e	stainless steel inlet mounting plate	R-F6017	
	brass inlet fitting, 3/8M-3/8M	MSR-A009-F	
f	8 mm copper tube, inlet fitting ↔ manifold	R-B6026-v1	
g	manifold Spirit Triplette 2-pump machine, complete	R-B6004-TC	see p. ...
h	brass combi valve (one-way/expansion)	R-B6101-IC	
i	6 mm copper tube, combi valve ↔ discharge hose	R-B6023	
j	black silicone hose, combi valve ↔ discharge pipe	R-B6079	4X8mm, 28cm
k	6 mm copper tube, combi valve ↔ water meter L	R-B6036-L	
l	6 mm copper tube, combi valve ↔ water meter C	R-B6036-TM	
m	6 mm copper tube, combi valve ↔ water meter R	R-B6036-TR	
n	water meter, complete (fittings, mounting plate)	R-E6131-C	see p. ...
o	6 mm copper tube, water meter ↔ heat exchanger	R-B6022-v1	
p	8 mm copper tube, manifold ↔ steam boiler	R-B6035	
q	6 mm copper tube, manifold ↔ mix-block	R-B6029-T	
r	mixblock Spirit, complete	R-B6003-C	see p. ...
s	8 mm copper tube, mix-block ↔ front fitting	R-B6031	
n.i.p.	6 mm copper tube, steam boiler ↔ mix-block	R-B6030	see p. 3 and 4



Triplette, pump per group; inlet to manifold to water meter and mix-block, exploded view

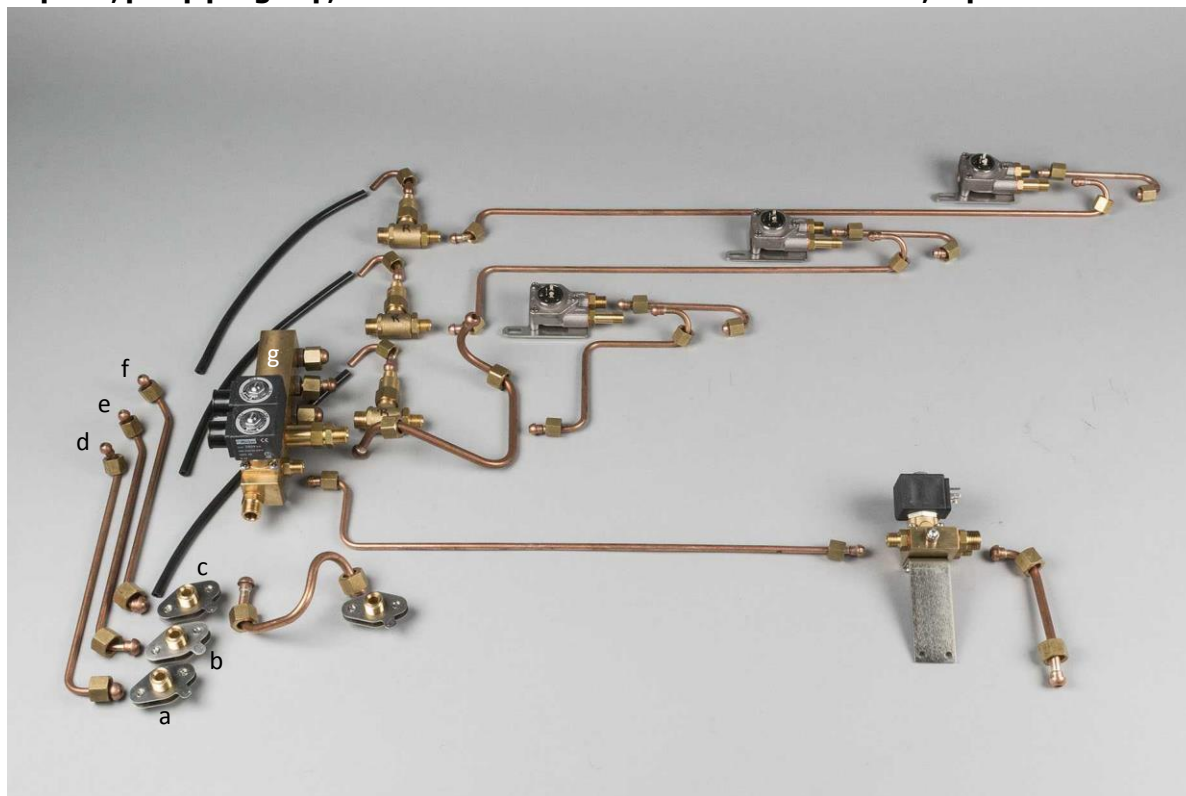

	Part	Number	remark
a	stainless steel mounting plate with nuts, marked "L"	R-F6018-L	
	stainless steel inlet mounting plate	R-F6017	
	brass inlet fitting, 3/8M-3/8M	MSR-A009-F	
b	stainless steel mounting plate with nuts, marked "C"	R-F6018-C	
	stainless steel inlet mounting plate	R-F6017	
	brass inlet fitting, 3/8M-3/8M	MSR-A009-F	
c	stainless steel mounting plate with nuts, marked "R"	R-F6018-R	
	stainless steel inlet mounting plate	R-F6017	
	brass inlet fitting, 3/8M-3/8M	MSR-A009-F	
d	6 mm copper tube, inlet fitting ↔ manifold L-gr	R-B6026-PL	
e	6 mm copper tube, inlet fitting ↔ manifold C-gr	R-B6026-PM	
f	6 mm copper tube, inlet fitting ↔ manifold R-gr	R-B6026-PR	
g	manifold Spirit Triplette, pump per group machine, complete	R-B6114-TC	see p. ...

all other items as previous page



Triplette; discharge, overview

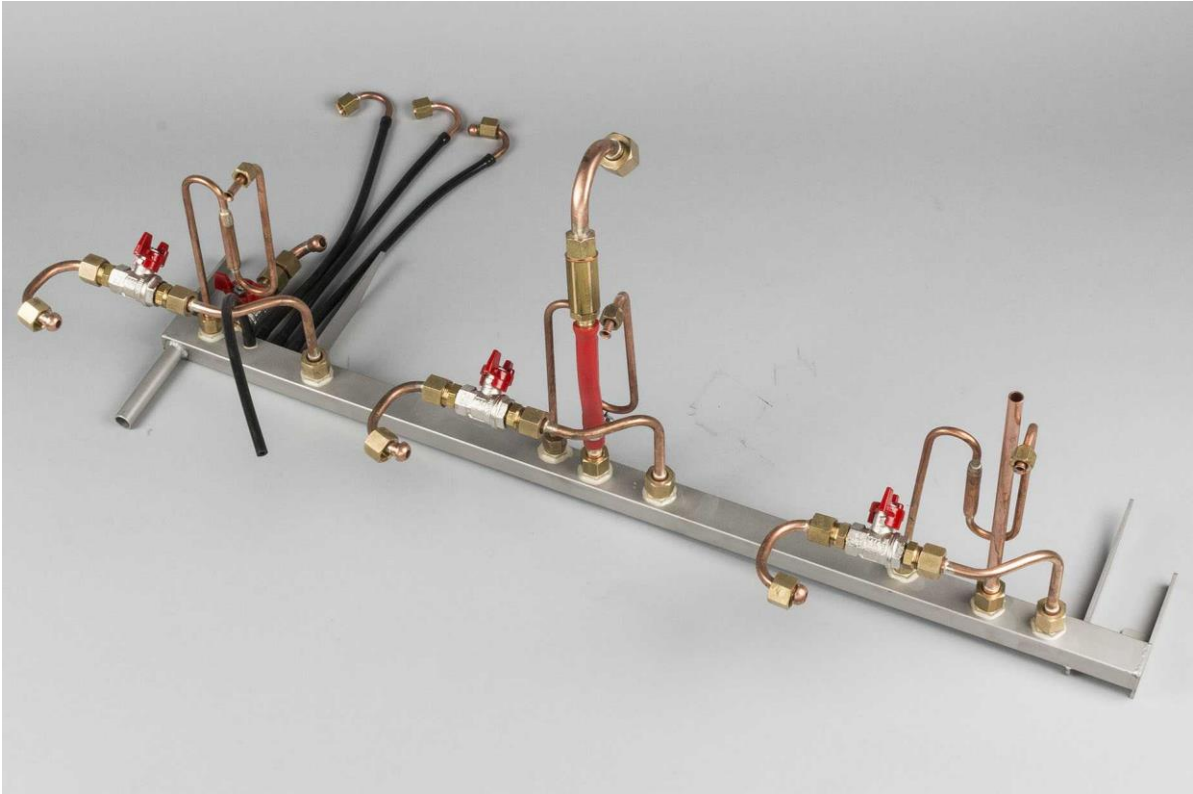

Triplette; steam boiler and ducts, overview

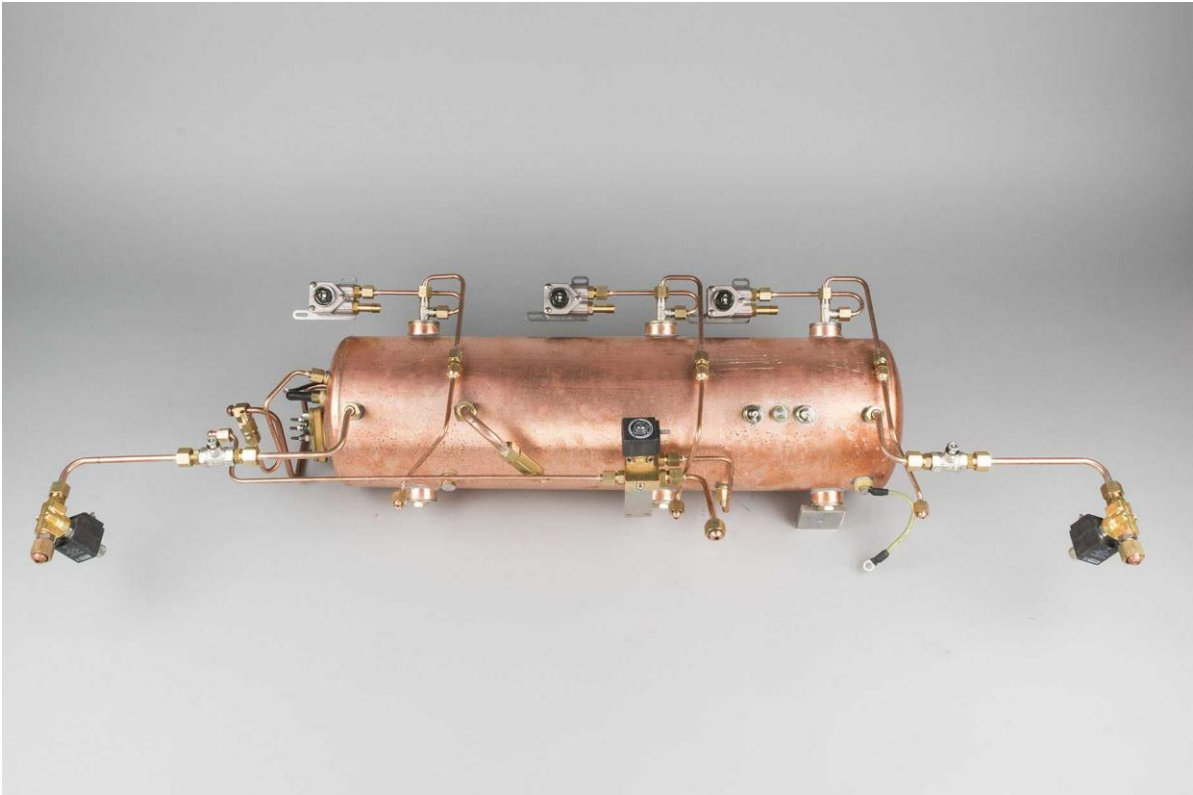

Triplette; discharge, exploded view

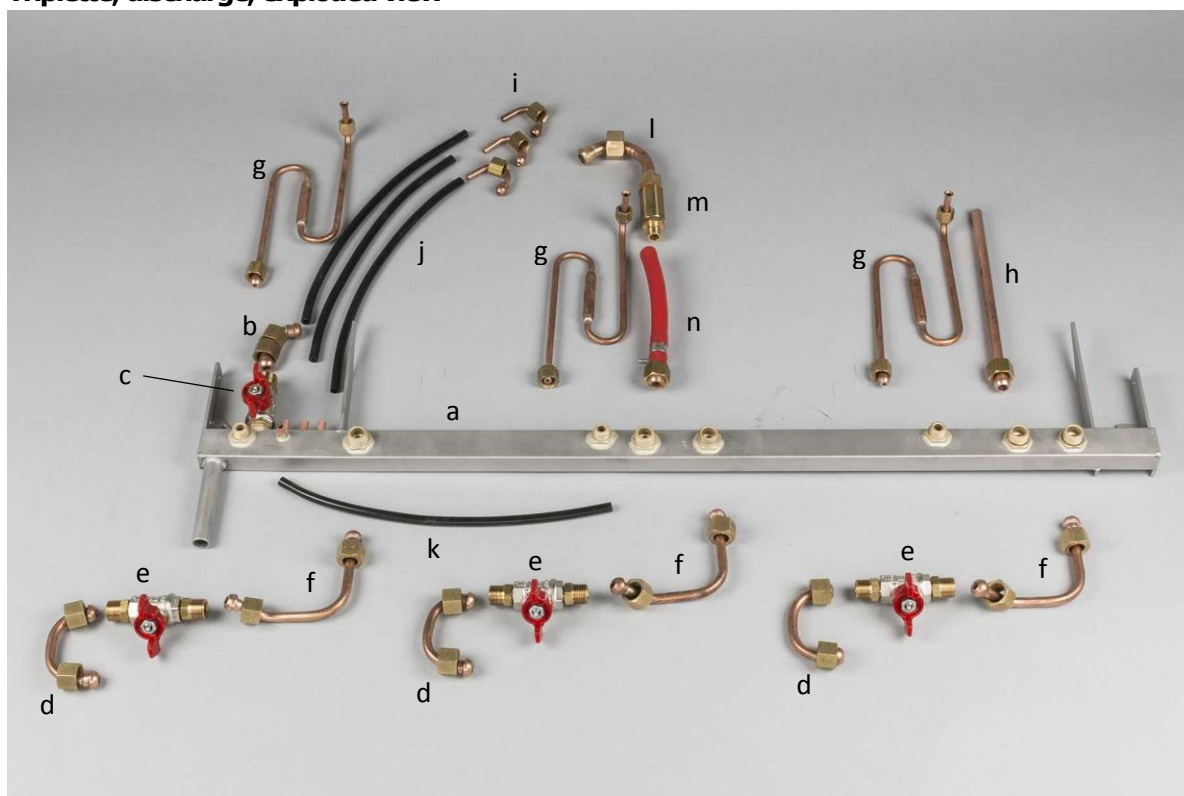

	Part	Number	remark
a	stainless steel main discharge pipe Triplette	R-B6025-T	
b	10 mm copper tube, steam boiler ↔ discharge valve	R-B6054	
c	butterfly handle ball valve and one fitting 1/4M-3/8M	MSR-B076 MSR-S037	
d	8 mm copper tube, coffee boiler ↔ discharge valve	R-B6050	
e	butterfly handle ball valve and two fittings 1/4M-3/8M	MSR-B076 MSR-037	as set: R-G6076-C
f	8 mm copper tube, discharge valve coffee boiler ↔ discharge pipe	R-B6051	
g	6 mm copper tube, group valve ↔ discharge pipe	R-B6052	
h	10 mm copper tube, discharge areator	R-B6053	
i	6 mm copper tube, combi valve ↔ discharge hose	R-B6023	
j	black silicone hose, combi valve ↔ discharge pipe	R-B6079	4X8mm, 28cm
k	black silicone hose, anti-vacuum valve ↔ discharge pipe	R-B6079	4X8mm, 28cm
l	12 mm copper tube, steam boiler ↔ pressure safety valve	MR-B081-T	
	copper ring 3/8	MSR-B078	as set: MR-B081-TC
m	brass pressure safety valve	MR-B032	
n	red silicone reinforced hose	R-B6070	8x14.5, 8.5cm
	8 mm copper tube with fitting nut	R-B6062 L-W0038	
	stainless steel hose clamp	C-HK-12-22	



Triplette; coffee boiler fill, exploded view

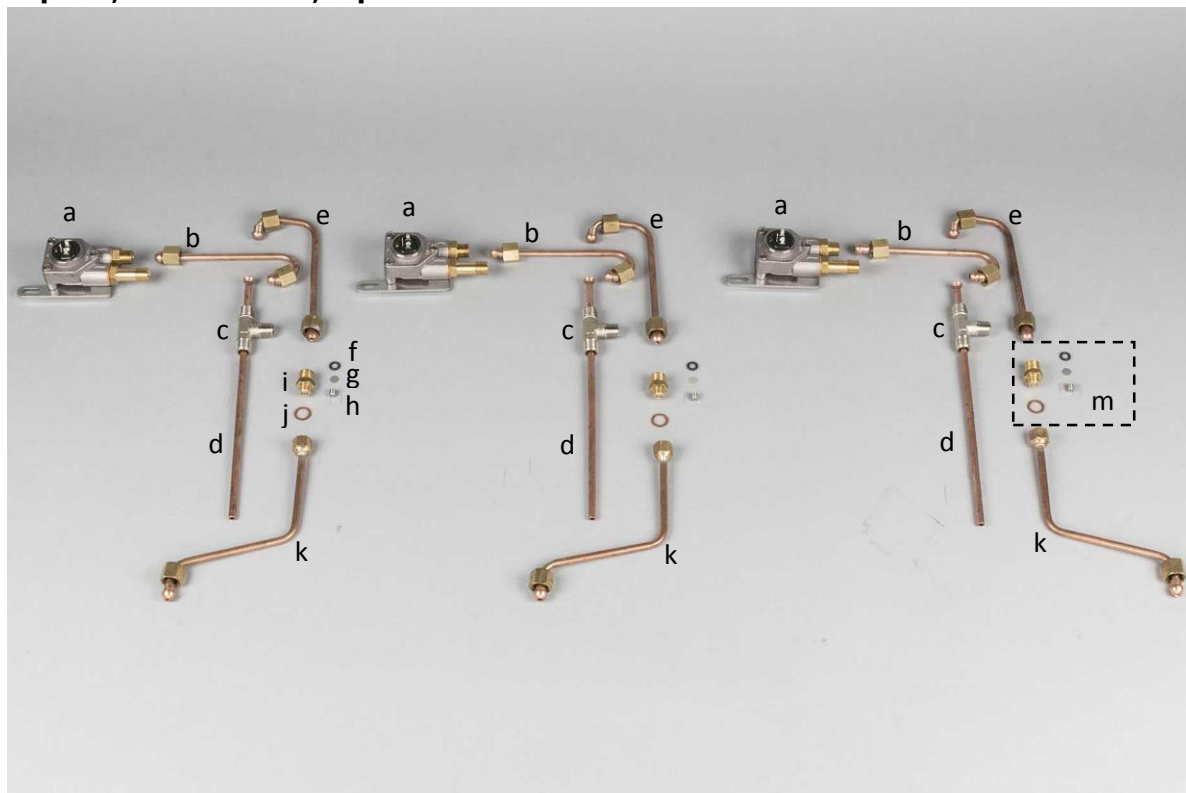

Part	Number	remark	
a	water meter, complete (fittings, mounting plate)	R-E6131-C	see p. ..
b	6 mm copper tube, water meter ↔ heat exchanger	R-B6022-v1	
c	nickel plated brass T-fitting, 1/4M	SR-B1008	
d	6 mm copper tube, injection tube in heat exchanger	R-B6037	
e	6 mm copper tube, heat exchanger ↔ restrictor	R-B6039-v1	
f	Viton O-ring in restrictor housing	MSR-G1007-A	
g	stainless steel mesh in restrictor housing	MSR-B036-B	
h	stainless steel restrictor, 0.5mm diameter	MSR-B034-05	
	stainless steel restrictor, 0.6mm diameter	MSR-B034-06	
	stainless steel restrictor, 0.7mm diameter	MSR-B034-07	
	stainless steel restrictor, 0.8mm diameter	MSR-B034-08	
i	brass restrictor housing, 1/4M-1/8M	MSR-B035-B	
j	copper O-ring 1/8	MSR-B082	
k	6 mm copper tube, restrictor ↔ coffee boiler	R-B6040	
m	restrictor in housing complete, 0.6 mm diameter	MSR-B035-C06	



Duette and Triplette; steam and hot water, (semi-) exploded view steam

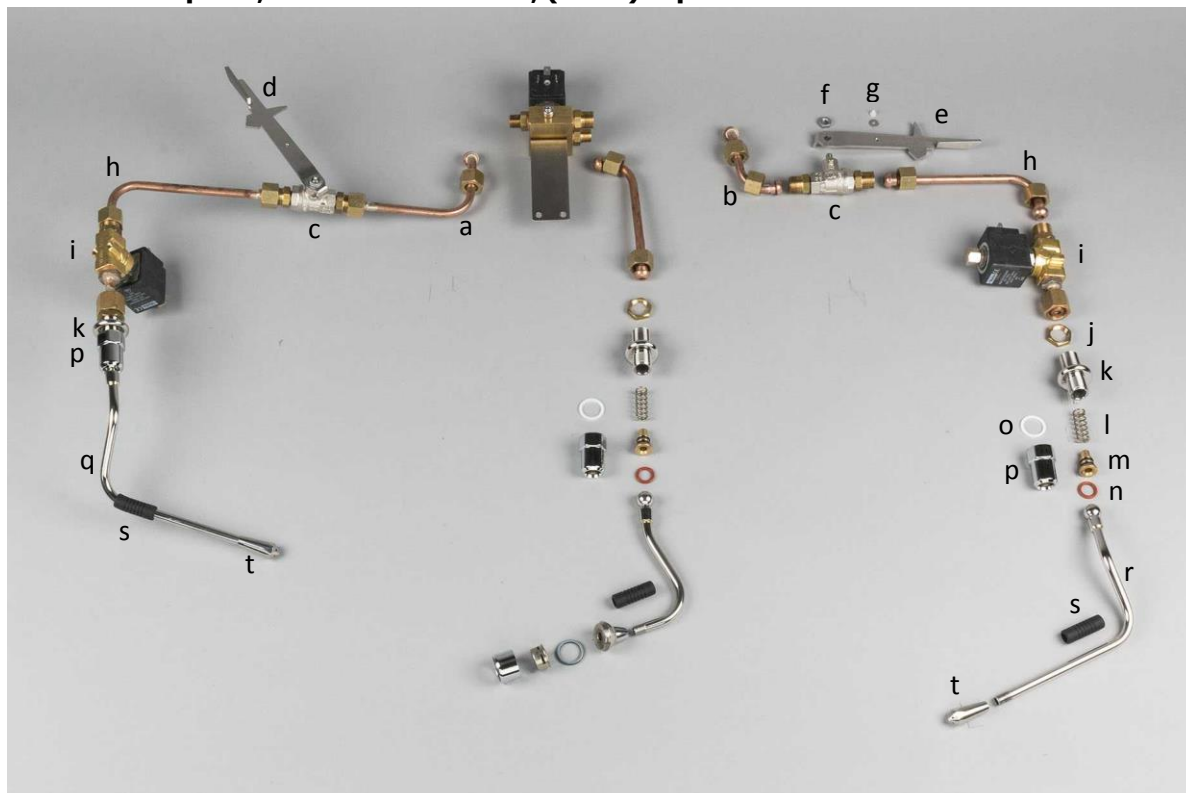

	Part	Number	remark
a	8 mm copper tube, steam boiler ↔ steam power left	R-B6056-L	
b	8 mm copper tube, steam boiler ↔ steam power right	R-B6056-R	
c	ball valve (used here without butterfly handle) and 2 brass fittings, 1/4M-3/8M	MSR-B076 MSR-B037	
d	stainless steel steam power valve handle left	R-S6110-L	
e	stainless steel steam power valve handle right	R-S6110-R	
f	stainless steel flat nut, M6 (is part of MSR-B076)		
g	plastic screw with stainless steel washer(s), M3	R-S6110-G	
h	8 mm copper tube, steam power ↔ steam valve	R-B6063	
i	steam solenoid valve w. fitting and tube	MR-S058-EC	
j	brass flat nut, 3/8	MSR-S009	
k	polished stainless steel front feed through	R-S6016	
l	stainless steel spring against wand plunger	MSR-S011-SP	
m	brass plunger w. 2 O-rings	MSR-S012-ST	
n	orange silicone O-ring	MSR-S013	
o	Teflon ring in conical nut	MSR-S014-R	
p	chromed bronze conical nut	MSR-S014-B	
q	polished stainless steel steam wand left	R-S6015-L	
r	polished stainless steel steam wand right	R-S6015-R	
s	rubber isolation sock for steam wand	MSR-S031	
t	stainless steel steam tip (1.6mm holes)	MR-S016	



Duette and Triplette; steam and hot water, (semi-) exploded view hot water

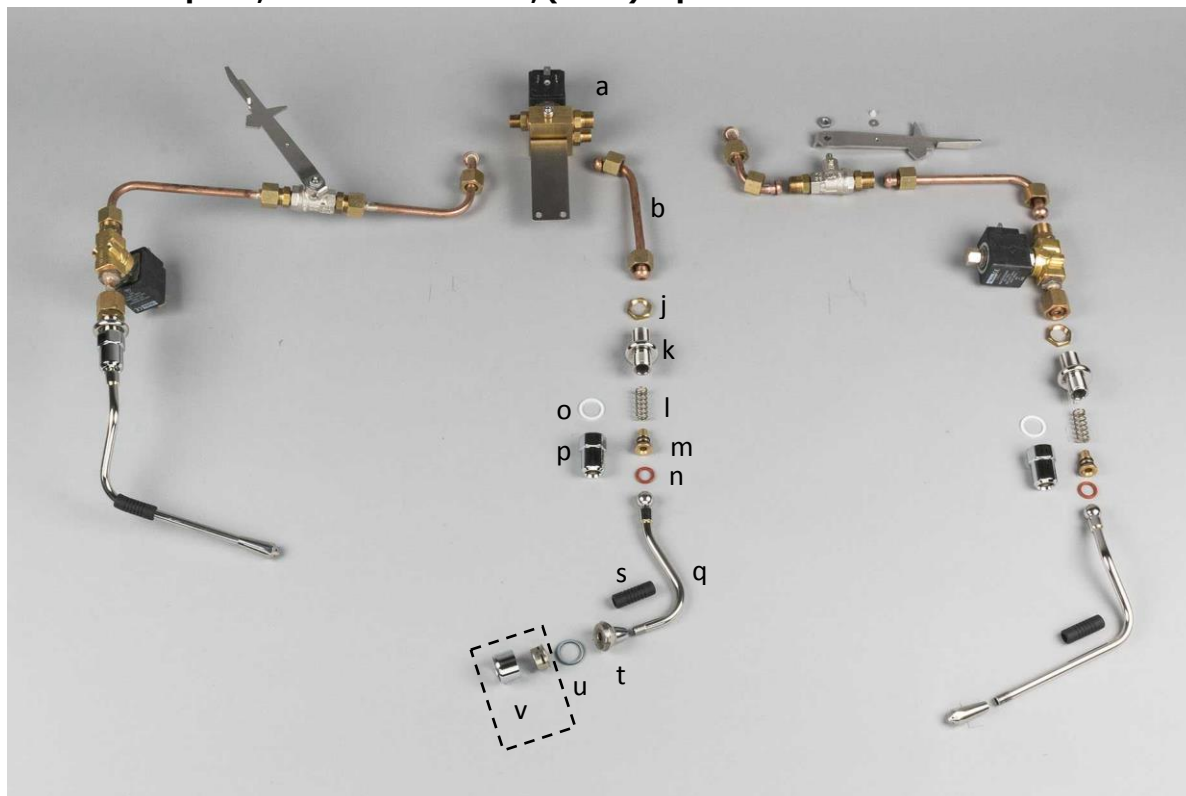

Part	Number	remark
a	R-B6003-C	mix-block complete w. mount see p. ..
b	R-B6031	8 mm copper tube, mix-block ↔ front feed through
j	MSR-S009	brass flat nut, 3/8
k	R-S6016	polished stainless steel front feed through
l	MSR-S011-SP	stainless steel spring against wand plunger
m	MSR-S012-ST	brass plunger w. 2 O-rings
n	MSR-S013	orange silicone O-ring
o	MSR-S014-R	Teflon ring in conical nut
p	MSR-S014-B	chromed bronze conical nut
q	R-S6017-v2	polished stainless steel hot water wand
s	MSR-S031	rubber isolation sock for steam wand
t	MSR-S018	stainless steel mushroom shaped shower adapter
u	MSR-S020-R	O-ring for water shower
v	MSR-S020	water shower with chromed fixture



Duette and Triplette pressure gauges

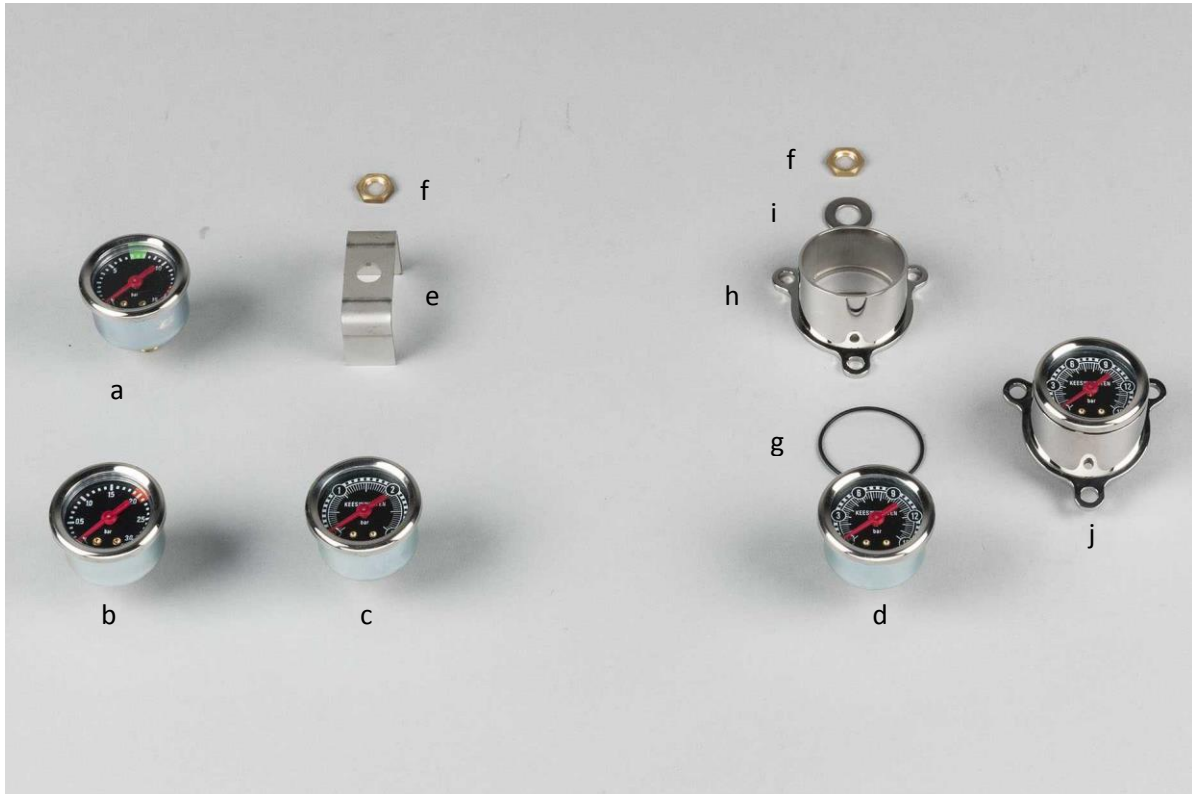

	Part	Number	remark
a	0-15 bar pressure gauge (coffee), no longer available	ZSR-B1031-P	replaced by d
b	0-3 bar pressure gauge (steam), no longer available	ZSR-B1031-S	replaced by c
c	0-3 bar pressure gauge (steam), KvdW version	S-B1031-SK	until # ..
d	0-15 bar pressure gauge (coffee), KvdW version	MSR-B1031-PK	
e	stainless steel mounting bracket for steam gauge	MS-F1020-S	until # ..
f	brass flat nut, 1/8	MSR-F065	
g	rubber O-ring, 37x1.5	R-B6081	
h	polished stainless steel gauge housing	R-F6020	
i	stainless steel washer, Din125A M8	C-RS-M8	
j	0-15 bar coffee boiler pressure gauge, complete	R-F6020-C	d+g+h+i



Duette and Triplette heating elements with fixtures



	Part	Number	remark
a	3-phase overheat protection switch, manual reset	MR-E033-3	155°C
b	stainless steel temperature probe clamp	MR-E130-S	
c	3x2000W 230V heating element, Triplette steam boiler	MR-E015	
d	Teflon O-ring for heating element	MR-B002	
e	3x1600W 230V heating element, Duette steam boiler	MR-E014	
f	stainless steel washer, Din125A M4	C-RS-M4	
g	stainless steel nut, Din934 M4	C-MH-M4	
h	alloy element spiral bridges (not used in Spirit)		
i	stainless steel washer, Din125A M8	C-RS-M8	
j	stainless steel lock washer, Din6797J M8	C-RO-M8	
k	stainless steel Allen bolt, Din912 M8x25	C-BZ-M8x25	
l	stainless steel Allen bolt with internal M4 threads	MR-B004	
m	brown plastic element cap	MR-E016	
n	stainless steel machine screw, Din7985 M4x35	C-SK-M4x35	
o	900W 230V heating element, coffee boiler	SR-E1020	
p	Viton O-ring, 39x4.5	SR-B1010-v2	
q	stainless steel spacer for element O-ring	SR-E1070	
r	brass nut, Din934 M8	SR-G1017	
s	black silicone hose, 30mm long	C-HS-ZZ10x14	



Evolution of handle versions in Spirit, overview

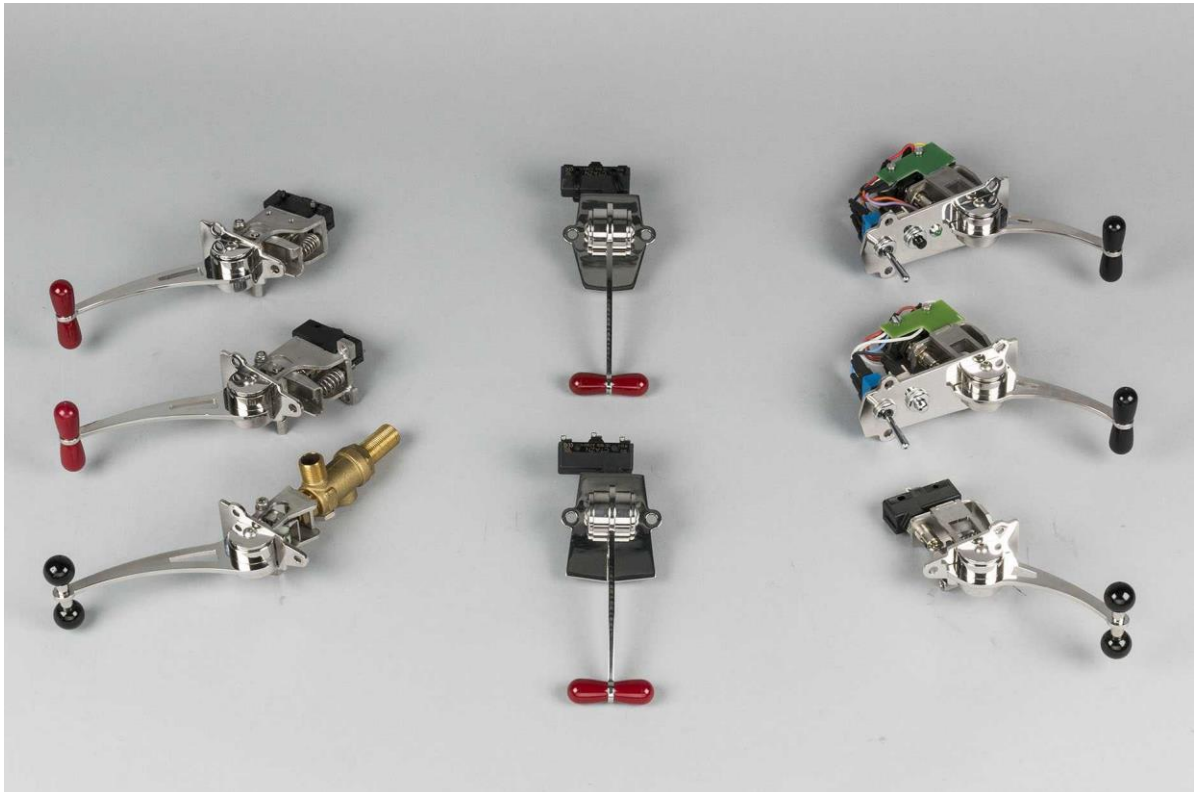

Left: steam handles version 1-2-3. Version 1 (bottom) is the mechanical steam valve. The mounting bracket of version 3 (top) is a bit different than that of version 2 (center).

Center: hot water handles version 1-2. Only the shape of the mounting bracket has changed from trapezoidal (bottom) to hexagonal (top).

Right: Bastone group handles versions 1-2-3. The earliest version (bottom) functions as a single switch without extra's. Program and volume switch were added (center) to offer better functionality and subsequently an indicator light (top).



Steam handle, mechanical version

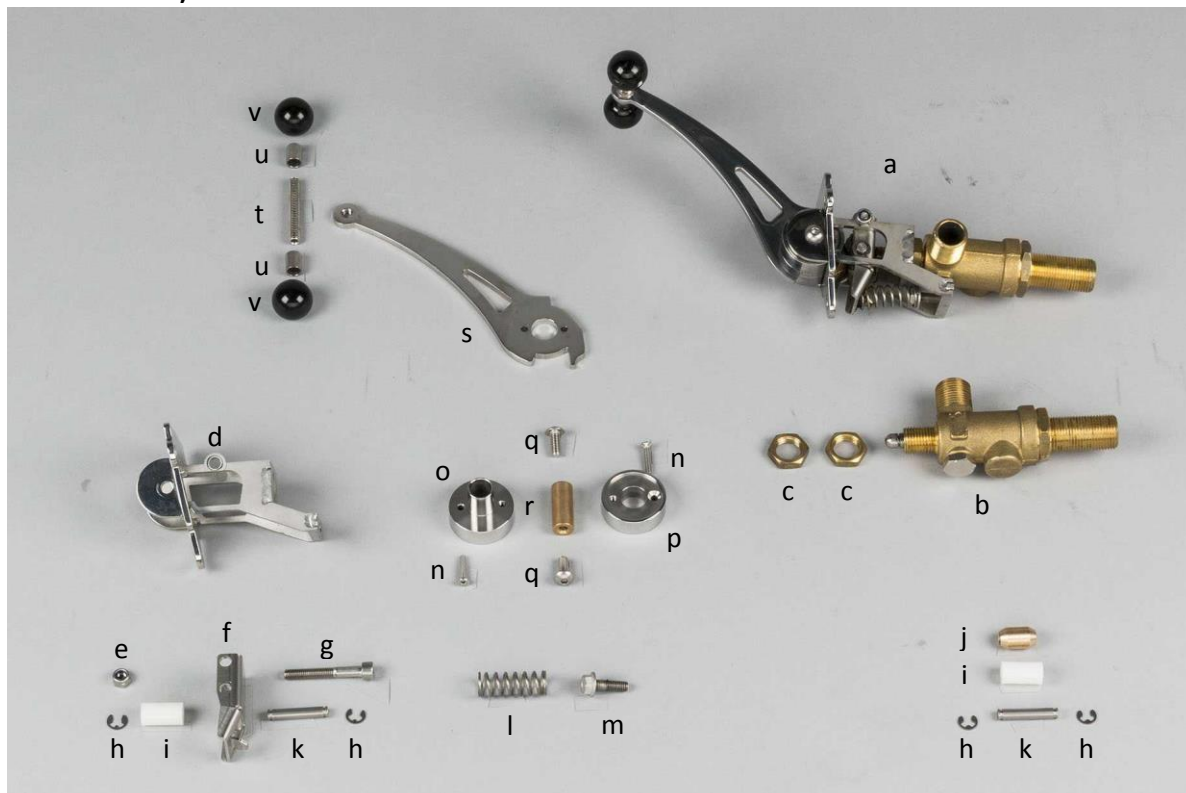

Part	Number	remark	
a	mechanical steam handle complete		
b	brass mechanical steam valve		
c	brass flat nut	VR-S6020-A	
d	polished stainless steel steam handle bracket, model 1	VR-S6003	
e	stainless steel lock nut, Din985 M5	C-MB-M5	
f	stainless steel swivel	VR-S6004	
g	stainless steel Allen bolt, Din912 M5x35	C-BZ-M5x35	
h	stainless steel circlip, Din6799 M5	C-VA-M5	
i	Teflon bushing for swivel, no longer available		replaced by j
j	bronze bushing for swivel	R-S6106	
k	stainless steel bushing axis	R-S6007	
l	stainless steel spring	MR-S6031	
m	steel set screw, M5 overall length 20mm	S-F1123	20mm
n	stainless steel Phillips machine screw, Din965 M3x16	C-SV-M3x16	
o	stainless steel handle spacer with protrusion	R-S6008-L	
p	stainless steel handle spacer without protrusion	R-S6008-K	
q	stainless steel Allen screw, ISO7380 M5x12	C-BI-M5x12	
r	bronze bushing for handle	R-S6005	
s	polished stainless steel steam valve handle	VR-S6002	
t	stainless steel set screw, Din916 M6x50	C-SS-M6x50	
u	polished stainless steel knob-spacer	ZSR-F1080-G	
v	black plastic handle knob, ball shaped, no longer available	ZSR-F1080-HZ	



Steam handle, electrical version

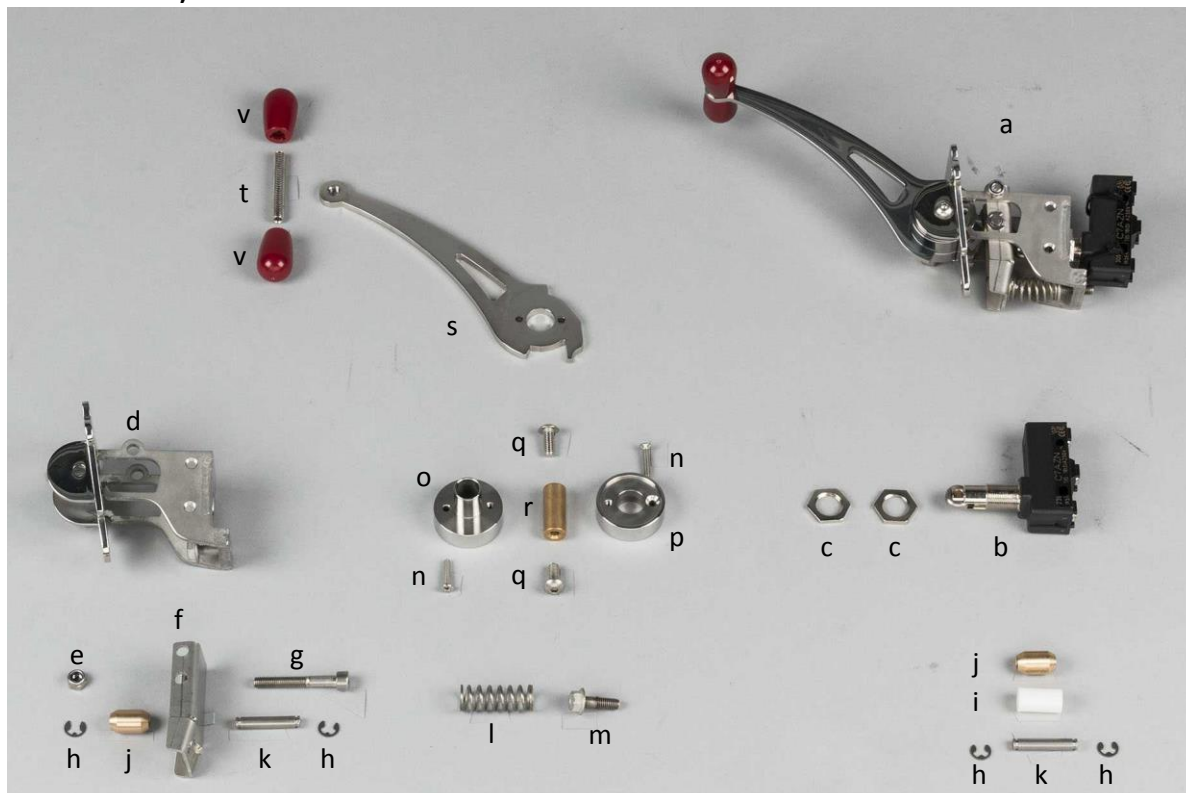

	Part	Number	remark
a	electric steam handle, complete	R-S6109-C	
b	wheel switch for steam valve	SR-E6060	
c	steel flat nut		
d	polished stainless steel steam handle bracket, model 3	R-S6103	retrofit model 2
e	stainless steel lock nut, Din985 M5	C-MB-M5	
f	stainless steel swivel	R-S6104	
g	stainless steel Allen bolt, Din912 M5x35	C-BZ-M5x35	
h	stainless steel circlip, Din6799 M5	C-VA-M5	
i	Teflon bushing for swivel, no longer available		replaced by j
j	bronze bushing for swivel	R-S6106	
k	stainless steel bushing axis	R-S6007	
l	stainless steel spring	MR-S6051	
m	steel set screw, M5 overall length 20mm	S-F1123	20mm
n	stainless steel Phillips machine screw, Din965 M3x16	C-V-M3x16	
o	stainless steel handle spacer with protrusion	R-S6008-L	
p	stainless steel handle spacer without protrusion	R-S6008-K	
q	stainless steel Allen screw, ISO7380 M5x12	C-BI-M5x12	
r	bronze bushing for handle	R-S6005	
s	polished stainless steel steam valve handle	R-S6102	
t	stainless steel set screw, Din916 M6x35	C-SS-M6x35	
v	red plastic handle knob, rugby-ball shaped	SR-F1081-HR	



Bastone group handle, version 1 (no switches)

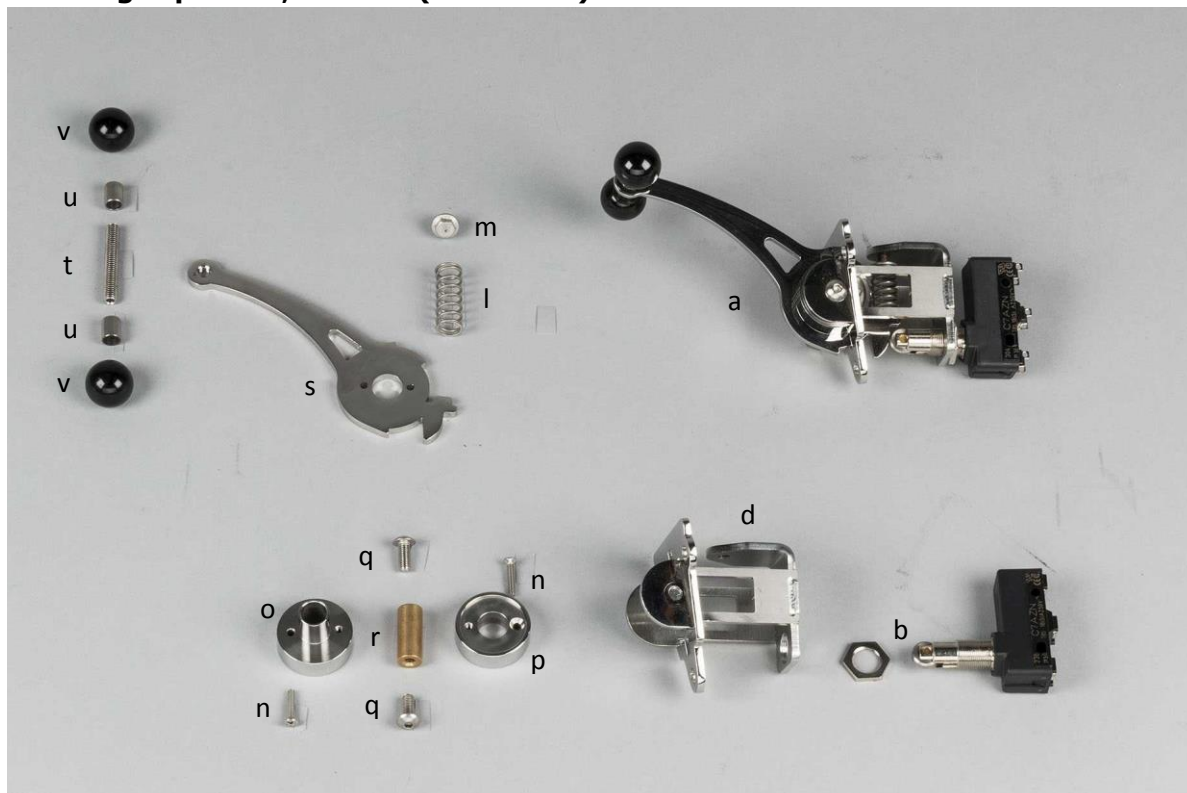

	Part	Number	remark
a	Bastone group handle version 1, complete		
b	wheel switch for steam valve w. flat nut	SR-E6060	
d	polished stainless steel group handle bracket, model 1	R-G6020*	set with s
l	stainless steel spring	MR-S6051	
m	steel set screw, M5 overall length 12mm		12mm
n	stainless steel Phillips machine screw, Din965 M3x16	C-SV-M3x16	
o	stainless steel handle spacer with protrusion	R-S6008-L	
p	stainless steel handle spacer without protrusion	R-S6008-K	
q	stainless steel Allen screw, ISO7380 M5x12	C-BI-M5x12	
r	bronze bushing for handle	R-S6005	
s	polished stainless steel group valve handle	R-G6020*	set with d
t	stainless steel set screw, Din916 M6x50	C-SS-M6x50	
u	polished stainless steel knob-spacer	ZSR-F1080-G	
v	black plastic handle knob, rugby-ball shaped	ZRS-F1080-HZ	



Bastone group handle, version 2 (with program and volume switch)

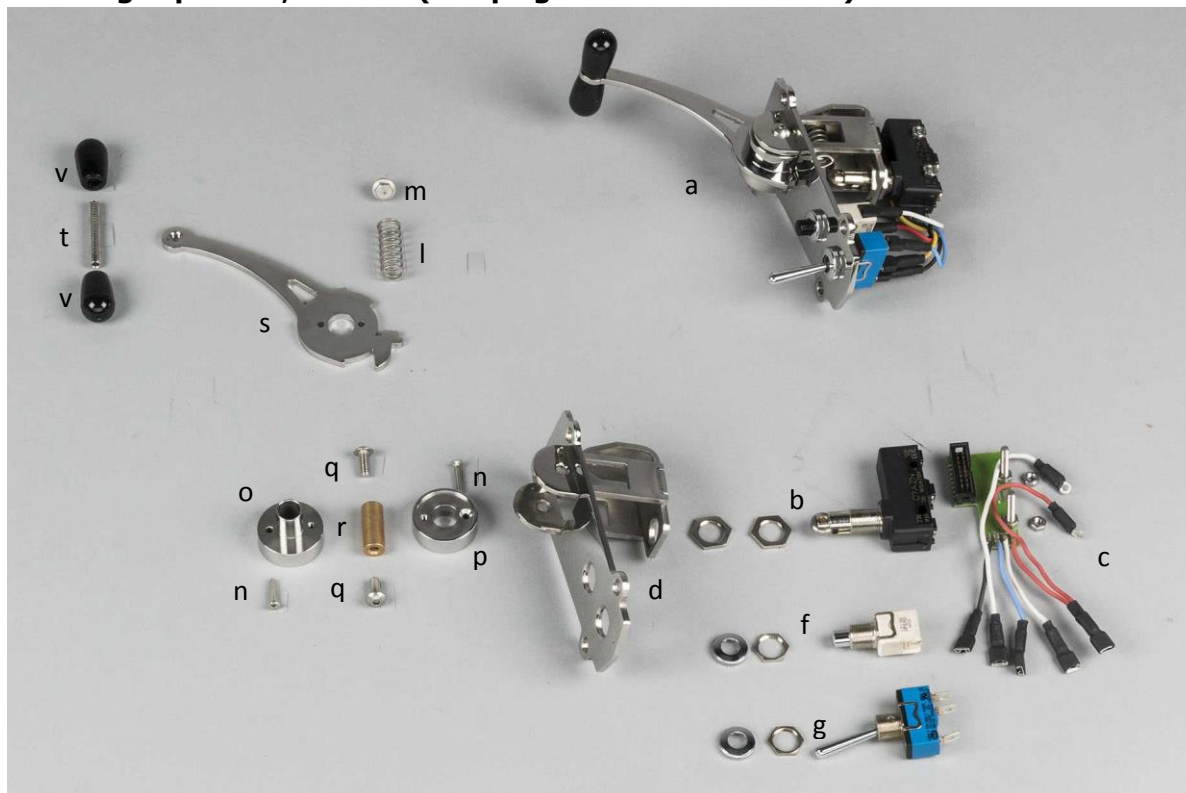

	Part	Number	remark
a	Bastone group handle version 2, complete	R-G6023-C	
b	wheel switch for steam valve w. 2 flat nuts	SR-E6060	
c	switch ↔ flat cable adapter w. 2 nuts, version 2		replaced by MR-E6063
d	polished stainless steel group handle bracket, model 2		
f	push button program switch w. fixtures, chrome button	VMR-E020-C	replaced by next
n.i.p.	push button program switch w. fixtures, black button	MR-E020-ZW	see a
g	toggle volume switch w. fixtures	MR-E6062	
l	stainless steel spring	MR-S6051	
m	steel set screw, M5 overall length 12mm		12mm
n	stainless steel Phillips machine screw, Din965 M3x16	C-SV-M3x16	
o	stainless steel handle spacer with protrusion	R-S6008-L	
p	stainless steel handle spacer without protrusion	R-S6008-K	
q	stainless steel Allen screw, ISO7380 M5x12	C-BI-M5x12	
r	bronze bushing for handle	R-S6005	
s	polished stainless steel group valve handle		
t	stainless steel set screw, Din916 M6x35	C-SS-M6x35	
v	black plastic handle knob, rugby-ball shaped	SR-F1081-HZ	



Bastone group handle, version 3 (with program and volume switches and indicator LED)

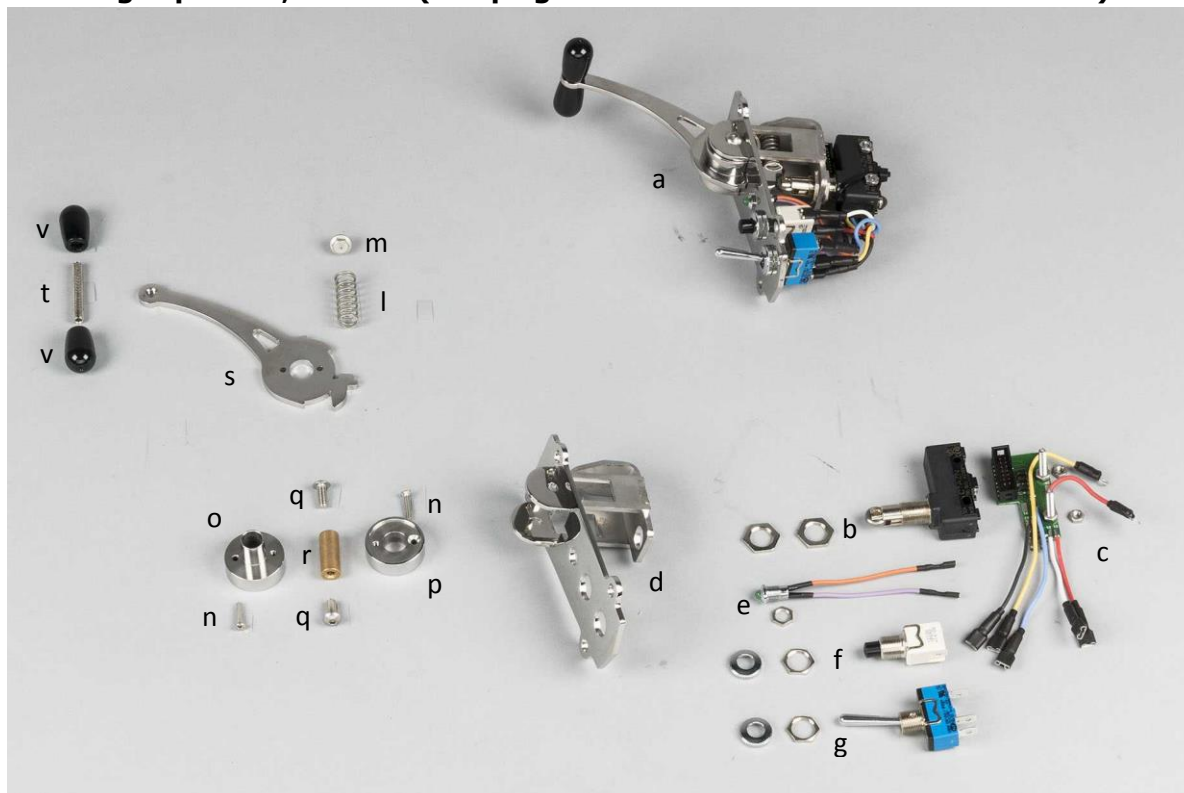

	Part	Number	remark
a	Bastone group handle version 3, complete	R-G6023-CL	
b	wheel switch for steam valve w. 2 flat nuts	SR-E6060	
c	switch ↔ flat cable adapter w. 2 nuts, version 3	MR-E6063	
d	polished stainless steel group handle bracket, model 3	R-G6022-C	
e	green small indicator LED with mounting nut		
f	push button program switch w. fixtures, black button	MR-E020-ZW	
n.i.p.	push button program switch w. fixtures, chrome button	VMR-E020-C	replaced by f
g	toggle volume switch w. fixtures	MR-E6062	
l	stainless steel spring	MR-S6051	
m	steel set screw, M5 overall length 12mm		12mm
n	stainless steel Phillips machine screw, Din965 M3x16	C-SV-M3x16	
o	stainless steel handle spacer with protrusion	R-S6008-L	
p	stainless steel handle spacer without protrusion	R-S6008-K	
q	stainless steel Allen screw, ISO7380 M5x12	C-BI-M5x12	
r	bronze bushing for handle	R-S6005	
s	polished stainless steel group valve handle		
t	stainless steel set screw, Din916 M6x35	C-SS-M6x35	
v	black plastic handle knob, rugby-ball shaped	SR-F1081-HZ	



Hot water handle, versions 1 and 2

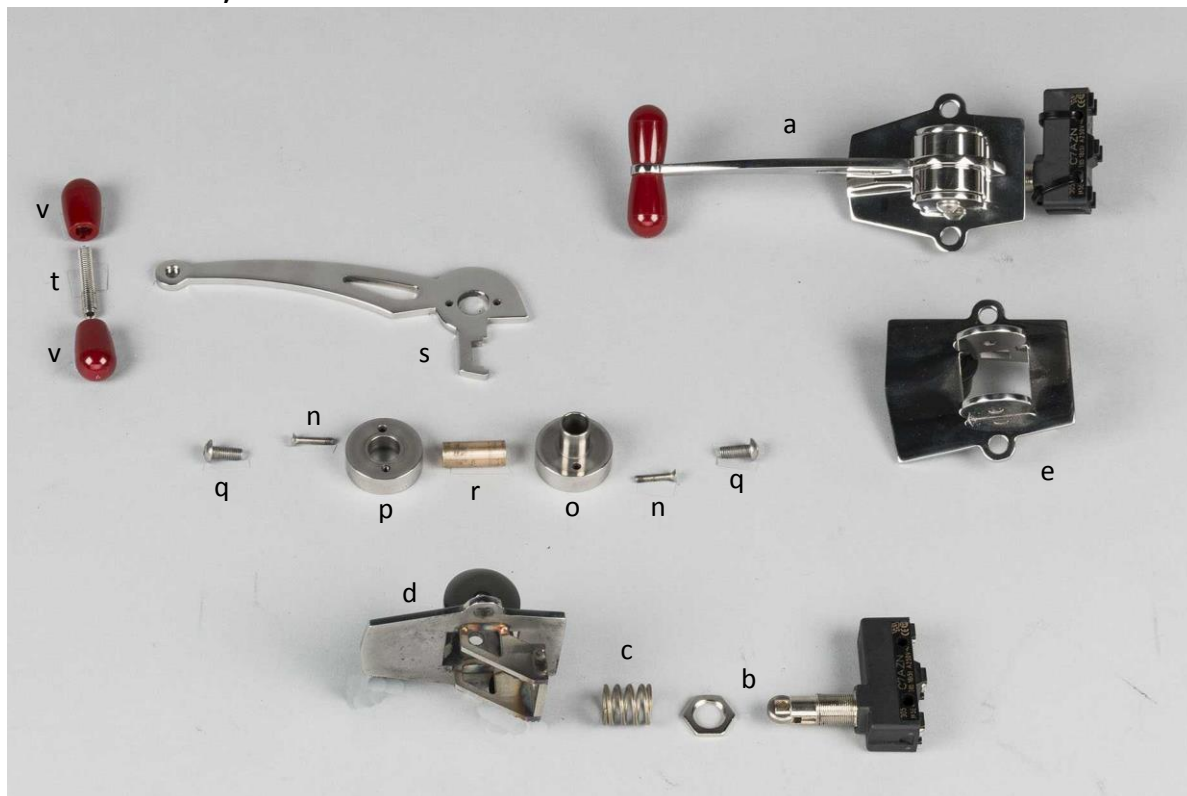

	Part	Number	remark
a	hot water handle version 2, complete	R-S6013-C	
b	wheel switch for steam valve w. flat nut	SR-E6060	
c	stainless steel spring	MSR-F126	
d	polished stainless steel hot water handle bracket, v2	R-S6010*	set with s
e	polished stainless steel hot water handle bracket, v1		replaced by d
n	stainless steel Phillips machine screw, Din965 M3x16	C-SV-M3x16	
o	stainless steel handle spacer with protrusion	R-S6008-L	
p	stainless steel handle spacer without protrusion	R-S6008-K	
q	stainless steel Allen screw, ISO7380 M5x12	C-BI-M5x12	
r	bronze bushing for handle	R-S6005	
s	polished stainless steel hot water handle	R-S6010*	set with d
t	stainless steel set screw, Din916 M6x35	C-SS-M6x35	
v	red plastic handle knob, rugby-ball shaped	SR-F1081-HR	



Duette and Triplette; mix-block (with stainless steel flange valve)

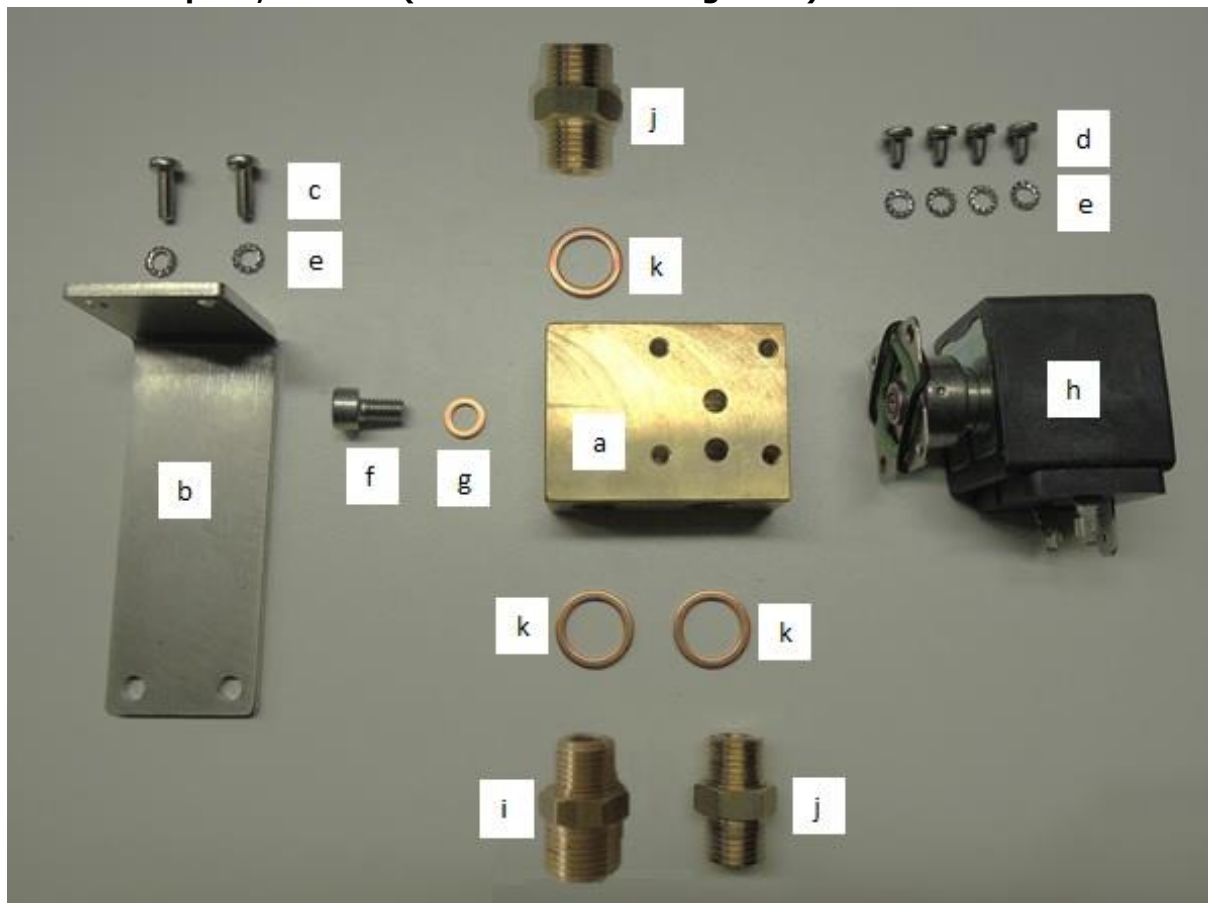

Part	Number	remark
a	R-B6003	brass mix-block Spirit (bare)
b	R-F6016	stainless steel mix-block support
c	C-SK-M4x12	stainless steel screw, Din7985 M4x12
d	C-SK-M4x06	stainless steel screw, Din7985 M4x6
e	C-RT-M4	stainless steel lock washer, Din6798A M4
f	C-BZ-M6x10	stainless steel Allen bolt, Din912 M6x10
g	MSR-G005	copper O-ring, M6
h	MSR-E6026-230	stainless steel 2-way flange valve, 230VAC
i	MSR-S037	brass fitting, 1/4M-3/8M
j	MSR-S036	brass fitting, 1/4M-1/4M
k	MSR-B079	copper O-ring, 1/4



Duette; manifold (with stainless steel flange valves)



	Part	Number	remark
a	brass manifold (bare)	R-B6004	
b	stainless steel 2-way flange valve, 230VAC	MSR-E6026-230	
c	stainless steel screw, Din7985 M4x6	C-SK-M4x06	
d	stainless steel lock washer, Din6798A M4	C-RT-M4	
e	stainless steel restrictor, 1.0mm (short)	MSR-B034-10	
f	stainless steel restrictor, 0.7mm	MSR-B034-07	
g	brass fitting, 1/4M-3/8M	MSR-S037	
h	brass fitting, 1/4M-1/4M	MSR-S036	
i	brass one-way valve, 3/8M - 3/8M	MR-B029	
j	copper O-ring, 1/4	MSR-B079	
k	copper O-ring, 3/8	MSR-B078	
l	chromed brass plug, 1/4M	MSR-B068	
m	8mm copper tube, manifold ↔ combi-valve (long)	R-B6024-L	
n	8mm copper tube, manifold ↔ combi-valve (short)	R-B6024	



Triplette; manifold (with stainless steel flange valves)

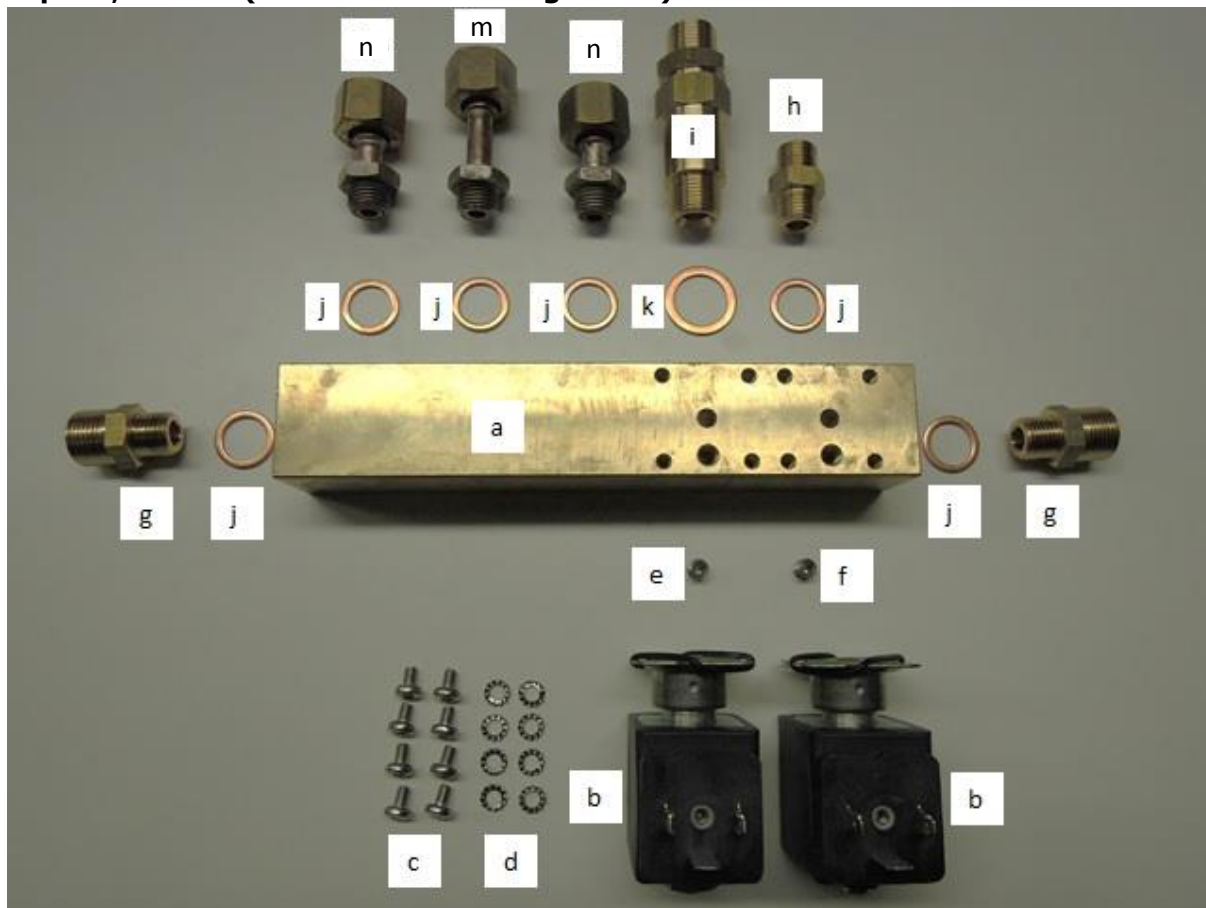

Part	Number	remark
a	R-B6004	
b	MSR-E6026-230	
c	C-SK-M4x06	
d	C-RT-M4	
e	MSR-B034-10	
f	MSR-B034-07	
g	MSR-S037	
h	MSR-S036	
i	MR-B029	
j	MSR-B079	
k	MSR-B078	
m	R-B6024-L	
n	R-B6024	



Duette, pump per group; manifold (with stainless steel flange valves)



Part	Number	remark
a	R-B6004	brass manifold (bare)
b	MSR-E6026-230	stainless steel 2-way flange valve, 230VAC
c	C-SK-M4x06	stainless steel screw, Din7985 M4x6
d	C-RT-M4	stainless steel lock washer, Din6798A M4
e	MSR-B034-10	stainless steel restrictor, 1.0mm (short)
f	MSR-B034-07	stainless steel restrictor, 0.7mm
g	MSR-S037	brass fitting, 1/4M-3/8M
h	MSR-S036	brass fitting, 1/4M-1/4M
i	MR-B029	brass one-way valve, 3/8M - 3/8M
j	MSR-B079	copper O-ring, 1/4
k	MSR-B078	copper O-ring, 3/8
l	MSR-B068	chromed brass plug, 1/4M
m	R-B6024-L	8mm copper tube, manifold ↔ combi-valve (long)
n	R-B6024	8mm copper tube, manifold ↔ combi-valve (short)



Triplette, pump per group; manifold (with stainless steel flange valves)

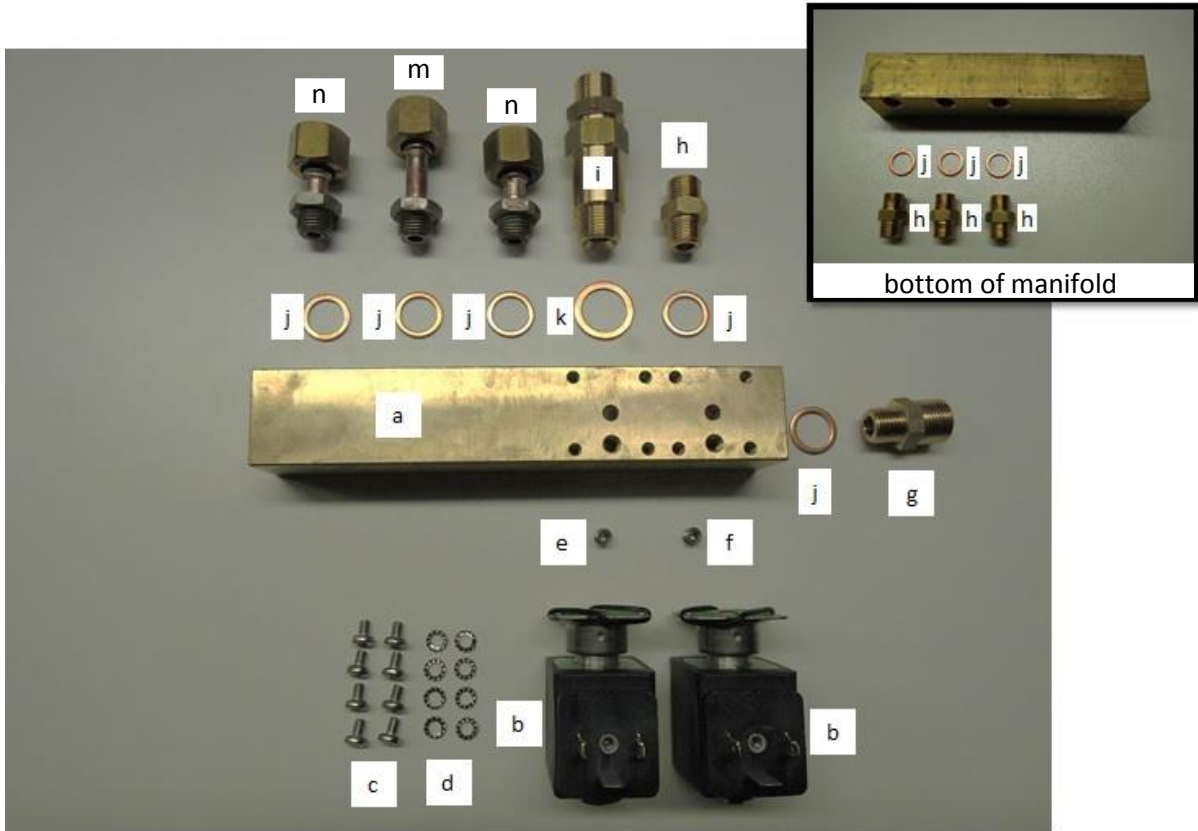

Part	Number	remark
a	R-B6004	brass manifold (bare)
b	MSR-E6026-230	stainless steel 2-way flange valve, 230VAC
c	C-SK-M4x06	stainless steel screw, Din7985 M4x6
d	C-RT-M4	stainless steel lock washer, Din6798A M4
e	MSR-B034-10	stainless steel restrictor, 1.0mm (short)
f	MSR-B034-07	stainless steel restrictor, 0.7mm
g	MSR-S037	brass fitting, 1/4M-3/8M
h	MSR-S036	brass fitting, 1/4M-1/4M
i	MR-B029	brass one-way valve, 3/8M - 3/8M
j	MSR-B079	copper O-ring, 1/4
k	MSR-B078	copper O-ring, 3/8
m	R-B6024-L	8mm copper tube, manifold ↔ combi-valve (long)
n	R-B6024	8mm copper tube, manifold ↔ combi-valve (short)

